



Ovela

Specifications Guide / Valid until April 2026

Please Note: Items are subject to change without prior notice. This spec book is missing some updated information, so to stay up to date with product specifications and modification options please use our digital spec book which can be found at <https://ezpricing.fabuwood.com/specbook>

Interactive Index

<u>Construction Specifications</u>	<u>III</u>	<u>Vanity Cabinets</u>	<u>26</u>
<u>Finish Specifications</u>	<u>V</u>	<u>Vanities</u>	<u>26</u>
<u>Q12®</u>	<u>VI</u>	<u>Waste Solutions</u>	<u>29</u>
<u>Limited Lifetime Warranty</u>	<u>VII</u>	<u>Base Accessories</u>	<u>30</u>
<u>Door Styles</u>	<u>VIII</u>	<u>Wall Accessories</u>	<u>37</u>
<u>Sample Doors</u>	<u>XI</u>	<u>Sink Accessories</u>	<u>38</u>
<u>Sales Tools</u>	<u>XVII</u>	<u>Appliance Accessories</u>	<u>39</u>
<u>Modifications</u>	<u>XX</u>	<u>Drawer Accessories</u>	<u>40</u>
<u>Wall Cabinets</u>	<u>1</u>	<u>Vanity Accessories</u>	<u>44</u>
<u>12" - 24" High Wall Cabinets</u>	<u>1</u>	<u>Wall Accessories</u>	<u>46</u>
<u>12" - 24" High & 24" Deep Wall Cabinets</u>	<u>2</u>	<u>Cabinet Accessories</u>	<u>48</u>
<u>30" High Wall Cabinets</u>	<u>3</u>	<u>Fillers</u>	<u>48</u>
<u>36" High Wall Cabinets</u>	<u>5</u>	<u>Columns</u>	<u>50</u>
<u>39" High Wall Cabinets</u>	<u>7</u>	<u>End Panels</u>	<u>51</u>
<u>42" High Wall Cabinets</u>	<u>9</u>	<u>Panels</u>	<u>52</u>
<u>Specialty Wall Cabinets</u>	<u>11</u>	<u>Wainscot Panels</u>	<u>53</u>
<u>Microwave Wall Cabinets</u>	<u>12</u>	<u>Moldings (8')</u>	<u>55</u>
<u>Wine Cabinets</u>	<u>14</u>	<u>Cabinet Lighting</u>	<u>56</u>
<u>Base Cabinets</u>	<u>15</u>	<u>Height Alignment Guide</u>	<u>58</u>
<u>Base Cabinets</u>	<u>15</u>		
<u>Drawer Base Cabinets</u>	<u>17</u>		
<u>Blind Base Cabinets</u>	<u>18</u>		
<u>Corner Base Cabinets</u>	<u>19</u>		
<u>Sink Base Cabinets</u>	<u>20</u>		
<u>Specialty Base Cabinets</u>	<u>21</u>		
<u>Tall Cabinets</u>	<u>22</u>		
<u>13" Deep Tall Pantry Cabinets</u>	<u>22</u>		
<u>24" Deep Tall Pantry Cabinets</u>	<u>23</u>		
<u>Oven Cabinets</u>	<u>24</u>		

Construction Specifications

Box

Ovela showcases frameless box construction with $\frac{3}{4}$ " plywood sides, top, and bottom. The $\frac{1}{2}$ " back panel is grooved into the side panels, and all interiors are finished with matching veneers for a cohesive, polished appearance.

Drawers

Ovela features a $\frac{5}{8}$ " thick solid wood dovetail drawer box with a $\frac{3}{8}$ " thick plywood bottom, mounted on Tandem plus Blumotion full-extension, soft-closing concealed runners. Each drawer showcases timeless craftsmanship with interlocking dovetail joints for lasting durability, while the integrated BLUMOTION Soft-Close technology ensures smooth, silent operation and supports a 75 lb dynamic load capacity. Interior drawer clearance height is 4".

Shelves

Shelves are built from $\frac{3}{4}$ " select veneered plywood with matching edge banding and premium metal shelf clips for durability. Fully adjustable shelves provide a cohesive interior finish and maximize storage flexibility. Base and tall cabinets include 22" deep shelves, wall cabinets $12\frac{1}{4}$ ", and vanity cabinets 19".

Hinges

Ovela cabinets are equipped with BLUM Concealed Clip-On Hinges featuring BLUMOTION Soft-Close, in-line plates, and Quick-Release Technology for ease of installation and long-term performance. Hinges are six-way adjustable and open at 110° to provide precise alignment and smooth operation.

Note: Lazy Susan, Easy Reach, and Wall Pie Cut cabinets do not feature the soft-close mechanism.

Toe Kick

Ovela features a thick plywood toe kick built directly into the cabinet base for structural integrity. This integrated toe kick design provides stability.

Toe kick for tall pantries and base corner cabinets will be shipped as a separate platform for easier installation.

Installation Note:

Ovela Cabinets are shipped with a protective film on the front face and edge-banding of all Doors, Front Panels, Wainscot Panels, Finished Accessories. Film is recommended to be removed after installation of cabinetry & job site construction is complete.

Construction Specifications

- 1 BLUM Concealed Clip-On Hinges, six-way adjustable, with BLUMOTION Soft-Close and Quick-Release Technology
- 2 5/8" solid wood dovetail drawer box with 3/8" plywood bottom and Tandem plus BLUMOTION full extension concealed runners.
- 3 3/4" edge-banding to match veneered natural plywood interiors
- 4 1/2" Plywood back panel
- 5 3/4" Plywood side panels
- 6 3/4" Plywood adjustable shelving
- 7 Recessed 3/4" plywood toe kick
- 8 Rubber bumpers on doors and drawers for silent closure
- 9 Horizontal 5" wide panel stretchers at front and rear for base cabinets
- 10 Base cabinet: 24"D with 23 3/8"D interior depth
- 11 Wall cabinets: 13"D with 12 3/4"D interior depth
- 12 Adjustable premium metal shelf clips

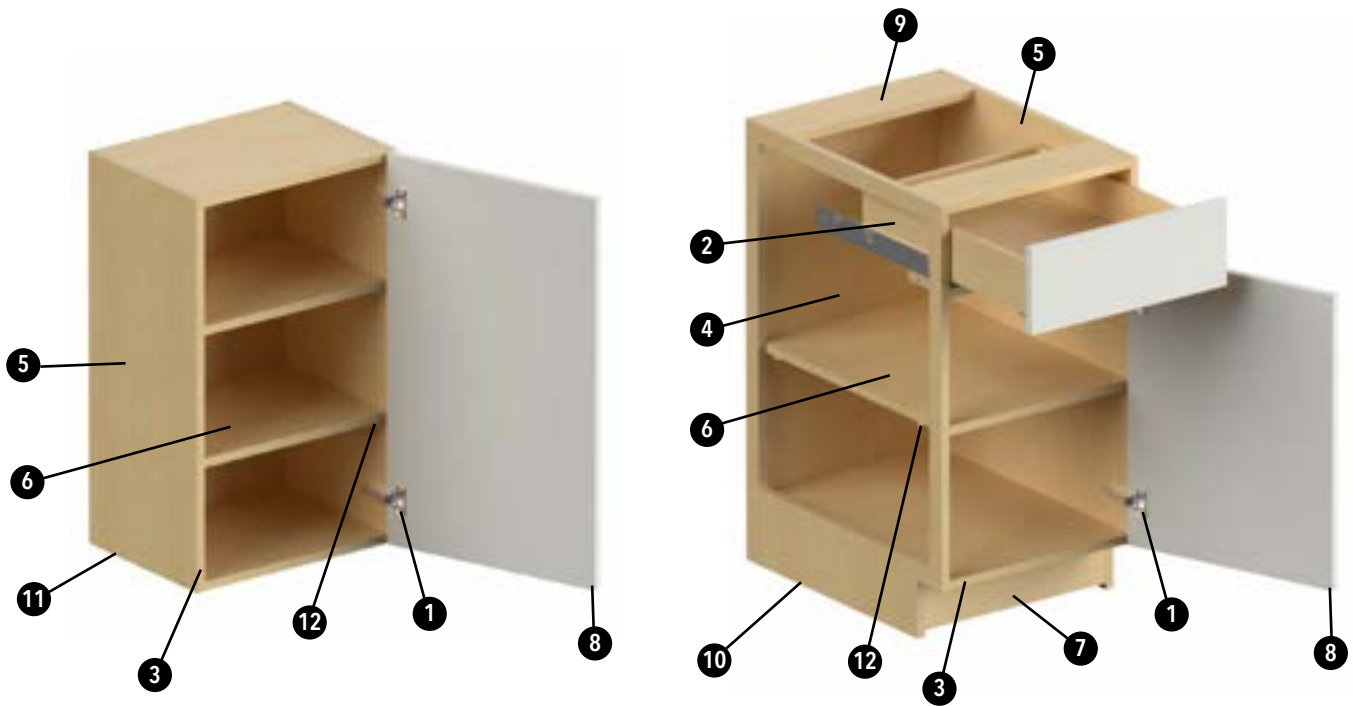

* Note for Cabinets with Adjustable Furniture Feet:
 The overall height dimensions listed throughout the specbook for these cabinets are **before** installation of the included foot attachment.

Featuring

Finish Specifications



Gloss Grigio

Gloss Finish

- 18mm thick / MDF / High Gloss Lacquered Surface
- Composed of a high-quality MDF board, pressed with a decorative paper infused with resins and protective elements.
- Top coat consisting of High Gloss Lacquer with UV drying applied to the front face
- Highly Scratch-Resistant: Unique qualities that allow it to be applied in environments with continuous contact of objects.
- High Gloss: Technology offers extraordinary beauty in its reflection and finishes.



Matte Carbone

Matte Finish

- 18mm thick / MDF / Matte Lacquered Surface
- Composed of a high-quality MDF board, pressed with a decorative paper infused with resins and protective elements.
- Top coat consisting of Matte Lacquer with UV curing applied to the front face.
- Silk Touch: Velvet and silk surface texture with extreme softness.
- Anti-Fingerprint: Innovative solution that stands out for its anti-fingerprint properties that prevent finger marks.
- Repair of Superficial Micro-Scratches (Self-Repairing): Technology used allows micro-scratches to be easily repaired.



Como Ash 2

Textured Finish

- 18mm thick / EFB / Resin-Based Coating with Textured Relief Details
- Composed of an Engineered Furniture Board (EFB) base, pressed with a decorative paper infused with resins and protective elements.
- Unique resin formula, for very realistic relief finishes with greater depth of detail.
- Natural-Look Finishes: Surfaces with great beauty, organic feel , and high decorative level.



What exactly defines a Q12 cabinet?

To fully achieve Q12 eligibility, a cabinet must encompass twelve unique standards of quality. Read below to learn more about the twelve fundamental pillars that establish the Q12 qualification:

Q1: CAREFULLY SELECTED ELEMENTS

To ensure the absolute integrity of our product, each element is carefully selected. We start by choosing only "Grade-A" materials and make no compromises along the way.

Q2: PRO-TOUCH TECHNIQUES

Our Allure and Ovela cabinets offer high-end finishes that are as beautiful as they are durable and practical. Fabuwood's distinctive pro-touch techniques allow for a sustainable and resilient cabinet finish that is not only easy to clean but will retain its beautiful luster for years.

Q3: ADVANCED CONSTRUCTION

Our Allure Dovetail and Ovela Threespine® construction methods are superior, innovative, and built for a lifetime of use. Fabuwood offers cabinets of the utmost strength, on par with the highest industry standards. Our attention to detail, coupled with advanced construction techniques, means a long lasting, superior quality cabinet every time.

Q4: ANTI-WARP STRUCTURES

All our cabinets are engineered in a way that eliminates warping, ensuring the cabinets hold up against elemental pressures. Crafted to perfection, every detailed component is created with unfailing durability. Each cabinet we produce is held to a high standard, ensuring long-lasting reliability.

Q5: METAL SHELF CLIPS

To maintain a maximum level of stability that preserves a shelf's longevity, these metal shelf clips assure sturdiness and durability. With this feature your shelves are sure to stand the test of time.

Q6: TOUGH BACK BUILDS

For superior structural longevity, the back builds on the Allure and Ovela series are built tough and easy to install. Our rigorous pressure testing guarantees that our products won't give in.

Q7: FLUSH FIT

To achieve an attractive appearance that is convenient and practical, our Q12 cabinets are built with a flush fit to ensure smooth surfaces and easy in-and-out access.

Q8: UNIQUE INTERIORS

The interior finish of our cabinets is as important as the exterior. Fabuwood offers high end, unique interior finishes for a clean and sophisticated look.

Q9: ONE-CLICK INSTALLATION

In addition to our soft-close action feature, the cutting-edge Blum Compact Clip Hinge allows for lightning-fast one-click installation and release.

Q10: FLUID FULL-EXTENSION

Our cabinets are built with smooth full-extension glides to guarantee an enhanced running action that maximizes its storage to full capacity. Fabuwood manufactures its cabinets with Blum's runners and soft-closing technology, utilizing space while also preventing damage and deterioration.

Q11: EZ LEVEL DRAWER FRONTS

On both framed and frameless products, to achieve an aesthetically graceful balance and ensure proper drawer alignment and function, our cabinets use an effortless system, utilizing a degree of mechanical precision for installing perfectly positioned drawer faces.

Q12: LIMITED LIFETIME WARRANTY

Our integrity-defining limited lifetime warranty is our commitment to quality and excellence. The warranty reflects our pledge to always back our cabinets while delivering an immaculate product. With precise crafting techniques, Q12 cabinets are poised for a lifetime of use.

Limited Lifetime Warranty

COVERAGE OF WARRANTY

Fabuwood Cabinetry Corp. ("Fabuwood") is pleased to provide the following limited warranty to the first residential purchaser on all cabinets sold in the United States and Canada by an authorized Fabuwood dealer. This warranty does not cover cabinets sold or shipped outside of the United States and Canada. A First Residential Purchaser ("First Residential Purchaser") is a person who purchases and installs the cabinets in a dwelling that is owned and used by that person as a primary or secondary home, or, in the case of a developer or builder, this limited warranty may be assigned to the initial purchaser who uses the dwelling as a primary or secondary home. This warranty, however, is not transferable to subsequent owners of the home. This limited warranty is subject to all limitations, exclusions, disclaimers and procedures set forth herein.

LIMITED LIFETIME WARRANTY (Only on Allure, Illume, Ovela, Value Premium, and Quest series cabinets): Fabuwood warrants to the First Residential Purchaser that all cabinets purchased from Fabuwood will be free from all unnatural defects in material and workmanship in accordance with Fabuwood's Quality Standards under normal residential use as long as the First Residential Purchaser owns the home in which such cabinets are installed.

EXCLUSIONS

THIS WARRANTY SUPERSEDES ANY AND ALL PREVIOUS WARRANTIES BY FABUWOOD AND CONSTITUTES THE EXCLUSIVE REMEDY AGAINST FABUWOOD FOR ALL DEFECTS, DAMAGES AND WORKMANSHIP. THERE ARE NO IMPLIED WARRANTIES EXTENDING BEYOND THE TERMS OF THIS WARRANTY. TO THE MAXIMUM EXTENT PERMITTED BY APPLICABLE LAW, FABUWOOD SHALL NOT BE LIABLE FOR ANY INDIRECT, SPECIAL, PUNITIVE, INCIDENTAL OR CONSEQUENTIAL COSTS, EXPENSES OR DAMAGES (INCLUDING LOST PROFITS), EVEN IF THIS LIMITED LIFETIME WARRANTY IS DEEMED TO HAVE FAILED OF ITS ESSENTIAL PURPOSE. SOME STATES DO NOT ALLOW THE EXCLUSION OR LIMITATION OF INCIDENTAL OR CONSEQUENTIAL DAMAGES, SO THE ABOVE LIMITATION OR EXCLUSION MAY NOT APPLY TO YOU. THIS WARRANTY GIVES YOU SPECIFIC LEGAL RIGHTS, AND YOU MAY ALSO HAVE OTHER RIGHTS, WHICH VARY FROM STATE TO STATE. IT IS POSSIBLE THAT ONE OR MORE OF THE LIMITATIONS AND EXCLUSIONS IN THIS WARRANTY MAY NOT APPLY TO YOU. THE LIMITED LIFETIME WARRANTY ON ALLURE, Ovela, VALUE PREMIUM AND QUEST SERIES CABINETS APPLIES ONLY TO PRODUCTS PURCHASED ON OR AFTER OCTOBER 1, 2024. VALUE PREMIUM & QUEST SERIES CABINETS PURCHASED PRIOR TO OCTOBER 1, 2024, AND ALLURE & Ovela SERIES CABINETS PURCHASED BEFORE JANUARY 26, 2023, ARE NOT INCLUDED IN THE LIMITED LIFETIME WARRANTY AND ARE SUBJECT TO FABUWOOD'S LIMITED 5-YEAR WARRANTY.

LIMITATIONS

This warranty shall become void if the cabinets, cabinetwork, drawer slides or hinges are modified from its original form, improperly installed or damaged prior to or during the installation, or used in any way other than for residential purposes. This warranty covers only parts and materials of the cabinets as supplied by Fabuwood. This warranty does not cover any products used or installed in connection with cabinets, such as gas or electric appliances, countertops, or plumbing fixtures. It also does not cover Blum hinges or any other third-party manufactured accessories or enhancements.

This warranty does not apply to products installed in locations that do not maintain year-round environmental controls. This warranty shall not apply to damages caused by transportation, storage, dirt, chemicals, exposure to moisture, humidity or excessive heat or cold, nor does it cover the effects arising from normal wear and tear, misuse, neglect, accidents, alterations, improper use or failure to maintain properly, house settling, or acts of God. No installer, retailer, distributor, agent or employee of Fabuwood has the authority to alter the obligations or limitations in this warranty.

QUALITY STANDARDS

This warranty covers all damages and unnatural defects that are deemed as such under the Fabuwood Quality Standards. The Fabuwood Quality Standards, which will be provided to you by your Fabuwood dealer upon request, should be reviewed at the time a claim for warranty service is being considered. Fabuwood reserves the right to modify or change the Fabuwood Quality Standards at any time without notice.

DISCLAIMERS

The following is a brief recap of some of the characteristics of the wood and finishes on the cabinets you are about to purchase. Please read them carefully. If some of these characteristics concern you, please choose something else. We bring these characteristics to your attention so you will realize that Fabuwood will not be held responsible for these variations in your cabinetry. It is important to note that wood products claimed as defective are most often the result of

atmospheric conditions such as excess moisture and humidity. Fabuwood strongly recommends testing the intended location of the products for such conditions prior to installation.

WOOD AND COLOR VARIATIONS: Wood is a product of nature, and since no two trees are alike, cabinets may vary in color, texture and grain. Wood characteristics naturally occurring such as variations in color, grain, mineral streaks, pinholes and knots are not considered defects. Color variations in cabinets are also a natural occurrence due to species, age, character of cabinets, and exposure to UV light, smoke, certain household cleaners, sunlight, extreme temperatures, and other environmental conditions. For these reasons, new and/or replacement cabinets may not match display samples and/or existing cabinets. This may result in overall color variations and is not considered a defect.

WOOD DOORS, DRAWER FRONTS, AND FACE FRAMES: Wood by nature will undergo expansion and contraction movements over the years as it compensates and adjusts to ever changing atmospheric humidity and temperature conditions. It is very common for center panels on doors to shrink, expand or move during these changes. Typically, the panel will return to its normal position within a year once it has adjusted to seasonal changes. It is for these same reasons that it is very common for doors to warp during these periods. Doors that are warped up to 1/4" are not considered defective. [Note: It is advisable to check if the door was properly installed, since doors that appear warped are very often the result of improper installation.] Painted doors, drawer fronts, and face frames may eventually have visible cracking around the joint areas, and cabinet colors may darken or lighten over time. These variations are considered to be the nature of the material in relation to their environmental exposure and are not covered under this Limited Lifetime Warranty.

PAINTED FINISHES: Plywood is a non-porous, smooth grained wood. Additionally, wood by nature undergoes periods of expansion and contraction while it adjusts to atmospheric conditions mentioned above. As such, finish stress lines may become visible on painted cabinets especially at the joints. Any such occurrence is not considered a defect.

GLAZED FINISHES: A glazed finish by character is an uneven finish. Some edges and profiles will be larger than others and glazing may vary cabinet to cabinet, door to drawer and item to item. This may result in overall color, texture, and finish variations but these are not considered defects.

WARRANTY PERFORMANCE

If a defect does occur within the terms and conditions of this warranty such defective part will be repaired or replaced by Fabuwood at its sole discretion. Fabuwood will not provide or pay for the cost of removal of defective product, transportation of defective, repaired or replaced product or installation of repaired or replaced product. If it is not commercially feasible to repair or replace a defective product, we may refund the original price paid by you for the defective product or provide a credit towards a similar type of product sold by us. Fabuwood will not be responsible for any shipping damages to the defective, replaced or repaired product. If defective item has been discontinued or is not available at the time, Fabuwood reserves the right to replace the item with the most similar item available in Fabuwood's inventory at that time. Fabuwood reserves the right to alter design, specifications and material without obligation to make similar changes to products previously manufactured. Fabuwood cannot guarantee that the finish of any replacement will exactly match the finish and appearance of the defective item due to the natural ageing process of the wood and finishes of the cabinets. Fabuwood may require at its discretion that the customer submit a clear photo, or that a company representative inspect the item being claimed before honoring this warranty.

CLAIMS

For a warranty claim made by the First Residential Purchaser to be considered, please contact the original Fabuwood-authorized dealer, who must file the claim through the Fabuwood EZ pricing system. In the event that the original dealer cannot be identified, or they have closed down, the warranty claim must be emailed to customerservice@fabuwood.com. The email should explain the issue and include pictures showing the claimed defects. Feel free to call +1 201-432-6555 ext. 1 for assistance.

NOTE

Please do not send back any items to Fabuwood prior to receiving proper Replacement Material Authorization ("RMA") from Warranty Support. Fabuwood takes no responsibility on any items sent back to Fabuwood without proper RMA.

Last Modified October 1, 2024: Change to include Value Premium, and Quest series cabinets under the Limited Lifetime Warranty. Previously Modified January 26, 2023: Change of the warranty on Allure and Ovela series cabinets from a Limited 5-year Warranty to the Limited Lifetime Warranty.

Door Styles

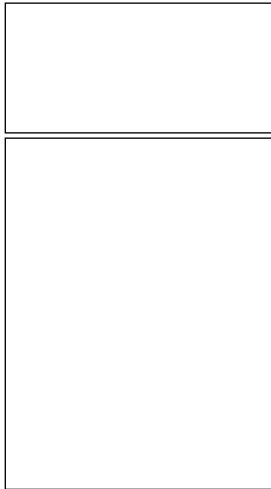

CATALINA

COLOR	FINISH
Bianco (ICBG)	Gloss
Grigio (ICGG)	Gloss
Bianco (ICBM)	Matte
Carbone (ICCM)	Matte
COMO ASH 2	Textured
MURATTI 1	Textured
MURATTI 4	Textured
NOCCE 3	Textured
OLMO 3	Textured

- Full Overlay Slab Door and Drawer Fronts (Euro Overlay with Frameless Box)
- Blum Clip-On Hinges with Blumotion Soft-Close and Quick-Release Technology (Blum Model#71B358E)
- Tandem plus Blumotion full extension concealed drawer runners
- Wood grain textures are not pattern matched

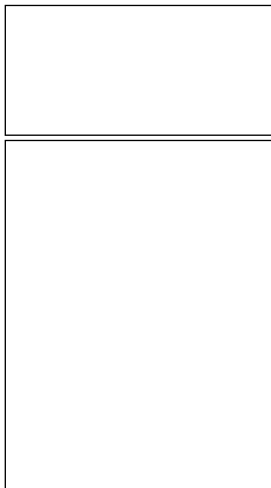

CATALINA DESIGNER'S COLLECTION

COLOR	FINISH
COMO ASH 1 (ICDC)	Textured
FRAPPE 1 (ICDC)	Textured
ICE CREAM 1 (ICDC)	Textured
IDA 1 (ICDC)	Textured
IDA 2 (ICDC)	Textured
NOCCE 1 (ICDC)	Textured
ROSALES 1 (ICDC)	Textured
ROSALES 2 (ICDC)	Textured
ROSALES 3 (ICDC)	Textured
WOODLINE 1 (ICDC)	Textured
WOODLINE 3 (ICDC)	Textured
WOODLINE 4 (ICDC)	Textured

- Full Overlay Slab Door and Drawer Fronts (Euro Overlay with Frameless Box)
- Blum Clip-On Hinges with Blumotion Soft-Close and Quick-Release Technology (Blum Model#71B358E)
- Tandem plus Blumotion full extension concealed drawer runners
- Wood grain textures are not pattern matched

Door Styles

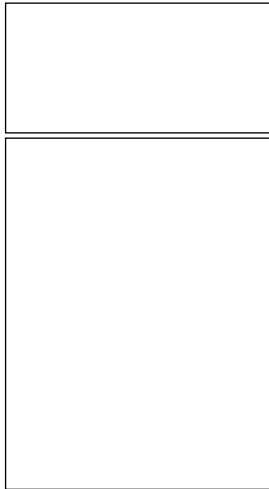

CATALINA DESIGNER'S COLLECTION CONT.

COLOR	FINISH
AGUA MARINA (ICDC)	Gloss
AZUL INDIGO (ICDC)	Gloss
AZUL MARINO (ICDC)	Gloss
BLACK (ICDC)	Gloss
BLANCO (ICDC)	Gloss
CASHMERE (ICDC)	Gloss
EUROLINE (ICDC)	Gloss
GRIS NUBE (ICDC)	Gloss
GUAYANA (ICDC)	Gloss
METALLO 1 (ICDC)	Gloss
METALLO 4 (ICDC)	Gloss
OLIVO (ICDC)	Gloss
TEXTIL PLATA (ICDC)	Gloss
AGUA MARINA (ICDC)	Matte
ANTRACITA (ICDC)	Matte
AZUL INDIGO (ICDC)	Matte
AZUL MARINO (ICDC)	Matte
BASALTO (ICDC)	Matte
BLACK (ICDC)	Matte
BLANCO (ICDC)	Matte
CASHMERE (ICDC)	Matte
GRIS PLOMO (ICDC)	Matte
VERDE SALVIA (ICDC)	Matte

- Full Overlay Slab Door and Drawer Fronts (Euro Overlay with Frameless Box)
- Blum Clip-On Hinges with Blumotion Soft-Close and Quick-Release Technology (Blum Model#71B358E)
- Tandem plus Blumotion full extension concealed drawer runners
- Wood grain textures are not pattern matched

Door Styles

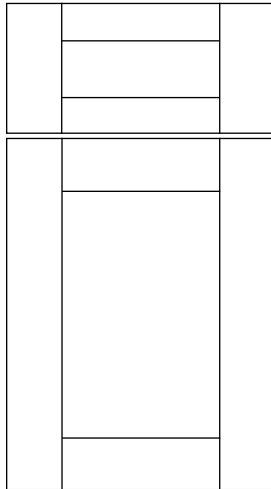

TUSCANY DESIGNER'S COLLECTION

COLOR	FINISH
COMO ASH 1 (ITDC)	Textured
COMO ASH 2 (ITDC)	Textured
FRAPPE 1 (ITDC)	Textured
IDA 1 (ITDC)	Textured
IDA 2 (ITDC)	Textured
MURATTI 1 (ITDC)	Textured
MURATTI 4 (ITDC)	Textured
NOCCE 1 (ITDC)	Textured
NOCCE 3 (ITDC)	Textured
OLMO 3 (ITDC)	Textured
ROSALES 1 (ITDC)	Textured
ROSALES 2 (ITDC)	Textured
ROSALES 3 (ITDC)	Textured
WOODLINE 1 (ITDC)	Textured
WOODLINE 3 (ITDC)	Textured
ANTRACITA (ITDC)	Matte
AZUL INDIGO (ITDC)	Matte
AZUL MARINO (ITDC)	Matte
BASALTO (ITDC)	Matte
BLANCO (ITDC)	Matte
CASHMERE (ITDC)	Matte

- Full Overlay 5-Piece & matching 5-piece Drawer Fronts (Euro Overlay with Frameless Box)
- Blum Clip-On Hinges with Blumotion Soft-Close and Quick-Release Technology (Blum Model#71B358E)
- Tandem plus Blumotion full extension concealed drawer runners
- Wood grain textures are not pattern matched

Sample Doors

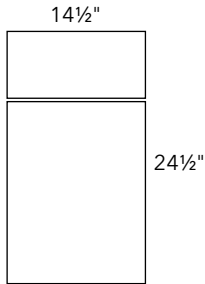

CATALINA DOOR SAMPLES WITH DRAWER FRONT

ITEM	DESCRIPTION
SDICBG	CATALINA BIANCO GLOSS SAMPLE DOOR
SDICGG	CATALINA GRIGIO GLOSS SAMPLE DOOR
SDICBM	CATALINA BIANCO MATTE SAMPLE DOOR
SDICCM	CATALINA CARBONE MATTE SAMPLE DOOR
SDICC2	CATALINA COMO ASH 2 SAMPLE DOOR
SDICM1	CATALINA MURATTI 1 SAMPLE DOOR
SDICM4	CATALINA MURATTI 4 SAMPLE DOOR
SDICN3	CATALINA NOCCE 3 SAMPLE DOOR
SDICO3	CATALINA OLMO 3 SAMPLE DOOR
SDIC COMO ASH 1	CATALINA COMO ASH 1 SAMPLE DOOR
SDIC FRAPPE 1	CATALINA FRAPPE 1 SAMPLE DOOR
SDIC ICE CREAM 1	CATALINA ICECREAM 1 SAMPLE DOOR
SDIC IDA 1	CATALINA IDA 1 SAMPLE DOOR
SDIC IDA 2	CATALINA IDA 2 SAMPLE DOOR
SDIC NOCCE 1	CATALINA NOCCE 1 SAMPLE DOOR
SDIC ROSALES 1	CATALINA ROSALES 1 SAMPLE DOOR
SDIC ROSALES 2	CATALINA ROSALES 2 SAMPLE DOOR
SDIC ROSALES 3	CATALINA ROSALES 3 SAMPLE DOOR
SDIC WOODLINE 1	CATALINA WOODLINE 1 SAMPLE DOOR
SDIC WOODLINE 3	CATALINA WOODLINE 3 SAMPLE DOOR
SDIC WOODLINE 4	CATALINA WOODLINE 4 SAMPLE DOOR
SDIC AGUA MARINA G	CATALINA AGUA MARINA GLOSS SAMPLE DOOR
SDIC AZUL INDIGO G	CATALINA AZUL INDIGO GLOSS SAMPLE DOOR
SDIC AZUL MARINO G	CATALINA AZUL MARINO GLOSS SAMPLE DOOR
SDIC BLACK G	CATALINA BLACK GLOSS SAMPLE DOOR
SDIC BLANCO G	CATALINA BLANCO GLOSS SAMPLE DOOR
SDIC CASHMERE G	CATALINA CASHMERE GLOSS SAMPLE DOOR
SDIC EUROLINE G	CATALINA EUROLINE GLOSS SAMPLE DOOR
SDIC GRIS NUBE G	CATALINA GRIS NUBE GLOSS SAMPLE DOOR
SDIC GUAYANA G	CATALINA GUAYANA GLOSS SAMPLE DOOR
SDIC METALLO 1 G	CATALINA METALLO 1 GLOSS SAMPLE DOOR
SDIC METALLO 4 G	CATALINA METALLO 4 GLOSS SAMPLE DOOR
SDIC OLIVO G	CATALINA OLIVO GLOSS SAMPLE DOOR
SDIC TEXTIL PLATA G	CATALINA TEXTIL PLATA GLOSS SAMPLE DOOR
SDIC AGUA MARINA M	CATALINA AGUA MARINA MATTE SAMPLE DOOR
SDIC ANTRACITA M	CATALINA ANTRACITA MATTE SAMPLE DOOR
SDIC AZUL INDIGO M	CATALINA AZUL INDIGO MATTE SAMPLE DOOR
SDIC AZUL MARINO M	CATALINA AZUL MARINO MATTE SAMPLE DOOR
SDIC BASALTO M	CATALINA BASALTO MATTE SAMPLE DOOR
SDIC BLACK M	CATALINA BLACK MATTE SAMPLE DOOR
SDIC BLANCO M	CATALINA BLANCO MATTE SAMPLE DOOR
SDIC CASHMERE M	CATALINA CASHMERE MATTE SAMPLE DOOR
SDIC GRIS PLOMO M	CATALINA GRIS PLOMO MATTE SAMPLE DOOR
SDIC VERDE SALVIA M	CATALINA VERDE SALVIA MATTE SAMPLE DOOR

Pricing Note: Sales Tools are NET pricing; virtual multiplier applies to these items. Final price listed on Quote/Order will reflect the virtual multiplier.

Sample Doors

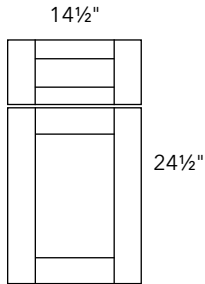

TUSCANY DOOR SAMPLES WITH DRAWER FRONT

ITEM	DESCRIPTION
SDIT COMO ASH 1	TUSCANY COMO ASH 1 SAMPLE DOOR
SDIT COMO ASH 2	TUSCANY COMO ASH 2 SAMPLE DOOR
SDIT FRAPPE 1	TUSCANY FRAPPE 1 SAMPLE DOOR
SDIT IDA 1	TUSCANY IDA 1 SAMPLE DOOR
SDIT IDA 2	TUSCANY IDA 2 SAMPLE DOOR
SDIT MURATTI 1	TUSCANY MURATTI 1 SAMPLE DOOR
SDIT MURATTI 4	TUSCANY MURATTI 4 SAMPLE DOOR
SDIT NOCCE 1	TUSCANY NOCCE 1 SAMPLE DOOR
SDIT NOCCE 3	TUSCANY NOCCE 3 SAMPLE DOOR
SDIT OLMO 3	TUSCANY OLMO 3 SAMPLE DOOR
SDIT ROSALES 2	TUSCANY ROSALES 2 SAMPLE DOOR
SDIT ROSALES 3	TUSCANY ROSALES 3 SAMPLE DOOR
SDIT WOODLINE 1	TUSCANY WOODLINE 1 SAMPLE DOOR
SDIT WOODLINE 3	TUSCANY WOODLINE 3 SAMPLE DOOR
SDIT ANTRACITA M	TUSCANY ANTRACITA MATTE SAMPLE DOOR
SDIT AZUL INDIGO M	TUSCANY AZUL INDIGO MATTE SAMPLE DOOR
SDIT AZUL MARINO M	TUSCANY AZUL MARINO MATTE SAMPLE DOOR
SDIT BASALTO M	TUSCANY BASALTO MATTE SAMPLE DOOR
SDIT BLANCO M	TUSCANY BLANCO MATTE SAMPLE DOOR
SDIT CASHMERE M	TUSCANY CASHMERE MATTE SAMPLE DOOR
SDIT VERDE SALVIA M	TUSCANY VERDE SALVIA MATTE SAMPLE DOOR

Pricing Note: Sales Tools are NET pricing; virtual multiplier applies to these items. Final price listed on Quote/Order will reflect the virtual multiplier.

Sample Doors

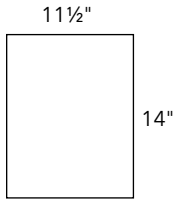

CATALINA SMALL DOOR SAMPLES

ITEM	DESCRIPTION
SDICBG-2	CATALINA BIANCO GLOSS SAMPLE DOOR 11 1/2" X 14"
SDICGG-2	CATALINA GRIGIO GLOSS SAMPLE DOOR 11 1/2" X 14"
SDICBM-2	CATALINA BIANCO MATTE SAMPLE DOOR 11 1/2" X 14"
SDICCM-2	CATALINA CARBONE MATTE SAMPLE DOOR 11 1/2" X 14"
SDICC2-2	CATALINA COMO ASH 2 SAMPLE DOOR 11 1/2" X 14"
SDICM1-2	CATALINA MURATTI 1 SAMPLE DOOR 11 1/2" X 14"
SDICM4-2	CATALINA MURATTI 4 SAMPLE DOOR 11 1/2" X 14"
SDICN3-2	CATALINA NOCCE 3 SAMPLE DOOR 11 1/2" X 14"
SDICO3-2	CATALINA OLMO 3 SAMPLE DOOR 11 1/2" X 14"
SDIC-2 COMO ASH 1	CATALINA COMO ASH 1 SAMPLE DOOR 11 1/2" X 14"
SDIC-2 FRAPPE 1	CATALINA FRAPPE 1 SAMPLE DOOR 11 1/2" X 14"
SDIC-2 ICE CREAM 1	CATALINA ICECREAM 1 SAMPLE DOOR 11 1/2" X 14"
SDIC-2 IDA 1	CATALINA IDA 1 SAMPLE DOOR 11 1/2" X 14"
SDIC-2 IDA 2	CATALINA IDA 2 SAMPLE DOOR 11 1/2" X 14"
SDIC-2 NOCCE 1	CATALINA NOCCE 1 SAMPLE DOOR 11 1/2" X 14"
SDIC-2 ROSALES 1	CATALINA ROSALES 1 SAMPLE DOOR 11 1/2" X 14"
SDIC-2 ROSALES 2	CATALINA ROSALES 2 SAMPLE DOOR 11 1/2" X 14"
SDIC-2 ROSALES 3	CATALINA ROSALES 3 SAMPLE DOOR 11 1/2" X 14"
SDIC-2 WOODLINE 1	CATALINA WOODLINE 1 SAMPLE DOOR 11 1/2" X 14"
SDIC-2 WOODLINE 3	CATALINA WOODLINE 3 SAMPLE DOOR 11 1/2" X 14"
SDIC-2 WOODLINE 4	CATALINA WOODLINE 4 SAMPLE DOOR 11 1/2" X 14"
SDIC-2 AGUA MARINA G	CATALINA AGUA MARINA GLOSS SAMPLE DOOR 11 1/2" X 14"
SDIC-2 AZUL INDIGO G	CATALINA AZUL INDIGO GLOSS SAMPLE DOOR 11 1/2" X 14"
SDIC-2 AZUL MARINO G	CATALINA AZUL MARINO GLOSS SAMPLE DOOR 11 1/2" X 14"
SDIC-2 BLACK G	CATALINA BLACK GLOSS SAMPLE DOOR 11 1/2" X 14"
SDIC-2 BLANCO G	CATALINA BLANCO GLOSS SAMPLE DOOR 11 1/2" X 14"
SDIC-2 CASHMERE G	CATALINA CASHMERE GLOSS SAMPLE DOOR 11 1/2" X 14"
SDIC-2 EUROLINE G	CATALINA EUROLINE GLOSS SAMPLE DOOR 11 1/2" X 14"
SDIC-2 GRIS NUBE G	CATALINA GRIS NUBE GLOSS SAMPLE DOOR 11 1/2" X 14"
SDIC-2 GUAYANA G	CATALINA GUAYANA GLOSS SAMPLE DOOR 11 1/2" X 14"
SDIC-2 METALLO 1 G	CATALINA METALLO 1 GLOSS SAMPLE DOOR 11 1/2" X 14"
SDIC-2 METALLO 4 G	CATALINA METALLO 4 GLOSS SAMPLE DOOR 11 1/2" X 14"
SDIC-2 OLIVO G	CATALINA OLIVO GLOSS SAMPLE DOOR 11 1/2" X 14"
SDIC-2 TEXTIL PLATA G	CATALINA TEXTIL PLATA GLOSS SAMPLE DOOR 11 1/2" X 14"
SDIC-2 AGUA MARINA M	CATALINA AGUA MARINA MATTE SAMPLE DOOR 11 1/2" X 14"
SDIC-2 ANTRACITA M	CATALINA ANTRACITA MATTE SAMPLE DOOR 11 1/2" X 14"
SDIC-2 AZUL INDIGO M	CATALINA AZUL INDIGO MATTE SAMPLE DOOR 11 1/2" X 14"
SDIC-2 AZUL MARINO M	CATALINA AZUL MARINO MATTE SAMPLE DOOR 11 1/2" X 14"
SDIC-2 BASALTO M	CATALINA BASALTO MATTE SAMPLE DOOR 11 1/2" X 14"
SDIC-2 BLACK M	CATALINA BLACK MATTE SAMPLE DOOR 11 1/2" X 14"
SDIC-2 BLANCO M	CATALINA BLANCO MATTE SAMPLE DOOR 11 1/2" X 14"
SDIC-2 CASHMERE M	CATALINA CASHMERE MATTE SAMPLE DOOR 11 1/2" X 14"
SDIC-2 GRIS PLOMO M	CATALINA GRIS PLOMO MATTE SAMPLE DOOR 11 1/2" X 14"
SDIC-2 VERDE SALVIA M	CATALINA VERDE SALVIA MATTE SAMPLE DOOR 11 1/2" X 14"

Pricing Note: Sales Tools are NET pricing; virtual multiplier applies to these items. Final price listed on Quote/Order will reflect the virtual multiplier.

Sample Doors

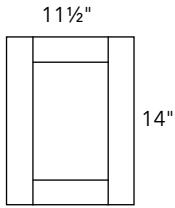

TUSCANY SMALL DOOR SAMPLES

ITEM	DESCRIPTION
SDIT-2 COMO ASH 1	TUSCANY COMO ASH 1 SAMPLE DOOR 11 1/2" X 14"
SDIT-2 COMO ASH 2	TUSCANY COMO ASH 2 SAMPLE DOOR 11 1/2" X 14"
SDIT-2 FRAPPE 1	TUSCANY FRAPPE 1 SAMPLE DOOR 11 1/2" X 14"
SDIT-2 IDA 1	TUSCANY IDA 1 SAMPLE DOOR 11 1/2" X 14"
SDIT-2 IDA 2	TUSCANY IDA 2 SAMPLE DOOR 11 1/2" X 14"
SDIT-2 MURATTI 1	TUSCANY MURATTI 1 SAMPLE DOOR 11 1/2" X 14"
SDIT-2 MURATTI 4	TUSCANY MURATTI 4 SAMPLE DOOR 11 1/2" X 14"
SDIT-2 NOCCE 1	TUSCANY NOCCE 1 SAMPLE DOOR 11 1/2" X 14"
SDIT-2 NOCCE 3	TUSCANY NOCCE 3 SAMPLE DOOR 11 1/2" X 14"
SDIT-2 OLMO 3	TUSCANY OLMO 3 SAMPLE DOOR 11 1/2" X 14"
SDIT-2 ROSALES 2	TUSCANY ROSALES 2 SAMPLE DOOR 11 1/2" X 14"
SDIT-2 ROSALES 3	TUSCANY ROSALES 3 SAMPLE DOOR 11 1/2" X 14"
SDIT-2 WOODLINE 1	TUSCANY WOODLINE 1 SAMPLE DOOR 11 1/2" X 14"
SDIT-2 WOODLINE 3	TUSCANY WOODLINE 3 SAMPLE DOOR 11 1/2" X 14"
SDIT-2 ANTRACITA M	TUSCANY ANTRACITA MATTE SAMPLE DOOR 11 1/2" X 14"
SDIT-2 AZUL INDIGO M	TUSCANY AZUL INDIGO MATTE SAMPLE DOOR 11 1/2" X 14"
SDIT-2 AZUL MARINO M	TUSCANY AZUL MARINO MATTE SAMPLE DOOR 11 1/2" X 14"
SDIT-2 BASALTO M	TUSCANY BASALTO MATTE SAMPLE DOOR 11 1/2" X 14"
SDIT-2 BLANCO M	TUSCANY BLANCO MATTE SAMPLE DOOR 11 1/2" X 14"
SDIT-2 CASHMERE M	TUSCANY CASHMERE MATTE SAMPLE DOOR 11 1/2" X 14"
SDIT-2 VERDE SALVIA M	TUSCANY VERDE SALVIA MATTE SAMPLE DOOR 11 1/2" X 14"

Pricing Note: Sales Tools are NET pricing; virtual multiplier applies to these items. Final price listed on Quote/Order will reflect the virtual multiplier.

Sample Doors

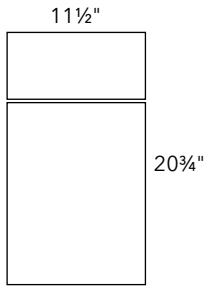

CATALINA MEDIUM DOOR SAMPLES WITH DRAWER FRONT

ITEM	DESCRIPTION
SDICBG-3	CATALINA BIANCO GLOSS SAMPLE DOOR 11 1/2" X 20"
SDICGG-3	CATALINA GRIGIO GLOSS SAMPLE DOOR 11 1/2" X 20"
SDICBM-3	CATALINA BIANCO MATTE SAMPLE DOOR 11 1/2" X 20"
SDICCM-3	CATALINA CARBONE MATTE SAMPLE DOOR 11 1/2" X 20"
SDICC2-3	CATALINA COMO ASH 2 SAMPLE DOOR 11 1/2" X 20"
SDICM1-3	CATALINA MURATTI 1 SAMPLE DOOR 11 1/2" X 20"
SDICM4-3	CATALINA MURATTI 4 SAMPLE DOOR 11 1/2" X 20"
SDICN3-3	CATALINA NOCCE 3 SAMPLE DOOR 11 1/2" X 20"
SDICO3-3	CATALINA OLMO 3 SAMPLE DOOR 11 1/2" X 20"
SDIC-3 COMO ASH 1	CATALINA COMO ASH 1 SAMPLE DOOR 11 1/2" X 20"
SDIC-3 FRAPPE 1	CATALINA FRAPPE 1 SAMPLE DOOR 11 1/2" X 20"
SDIC-3 ICE CREAM 1	CATALINA ICECREAM 1 SAMPLE DOOR 11 1/2" X 20"
SDIC-3 IDA 1	CATALINA IDA 1 SAMPLE DOOR 11 1/2" X 20"
SDIC-3 IDA 2	CATALINA IDA 2 SAMPLE DOOR 11 1/2" X 20"
SDIC-3 NOCCE 1	CATALINA NOCCE 1 SAMPLE DOOR 11 1/2" X 20"
SDIC-3 ROSALES 1	CATALINA ROSALES 1 SAMPLE DOOR 11 1/2" X 20"
SDIC-3 ROSALES 2	CATALINA ROSALES 2 SAMPLE DOOR 11 1/2" X 20"
SDIC-3 ROSALES 3	CATALINA ROSALES 3 SAMPLE DOOR 11 1/2" X 20"
SDIC-3 WOODLINE 1	CATALINA WOODLINE 1 SAMPLE DOOR 11 1/2" X 20"
SDIC-3 WOODLINE 3	CATALINA WOODLINE 3 SAMPLE DOOR 11 1/2" X 20"
SDIC-3 WOODLINE 4	CATALINA WOODLINE 4 SAMPLE DOOR 11 1/2" X 20"
SDIC-3 AGUA MARINA G	CATALINA AGUA MARINA GLOSS SAMPLE DOOR 11 1/2" X 20"
SDIC-3 AZUL INDIGO G	CATALINA AZUL INDIGO GLOSS SAMPLE DOOR 11 1/2" X 20"
SDIC-3 AZUL MARINO G	CATALINA AZUL MARINO GLOSS SAMPLE DOOR 11 1/2" X 20"
SDIC-3 BLACK G	CATALINA BLACK GLOSS SAMPLE DOOR 11 1/2" X 20"
SDIC-3 BLANCO G	CATALINA BLANCO GLOSS SAMPLE DOOR 11 1/2" X 20"
SDIC-3 CASHMERE G	CATALINA CASHMERE GLOSS SAMPLE DOOR 11 1/2" X 20"
SDIC-3 EUROLINE G	CATALINA EUROLINE GLOSS SAMPLE DOOR 11 1/2" X 20"
SDIC-3 GRIS NUBE G	CATALINA GRIS NUBE GLOSS SAMPLE DOOR 11 1/2" X 20"
SDIC-3 GUAYANA G	CATALINA GUAYANA GLOSS SAMPLE DOOR 11 1/2" X 20"
SDIC-3 METALLO 1 G	CATALINA METALLO 1 GLOSS SAMPLE DOOR 11 1/2" X 20"
SDIC-3 METALLO 4 G	CATALINA METALLO 4 GLOSS SAMPLE DOOR 11 1/2" X 20"
SDIC-3 OLIVO G	CATALINA OLIVO GLOSS SAMPLE DOOR 11 1/2" X 20"
SDIC-3 TEXTIL PLATA G	CATALINA TEXTIL PLATA GLOSS SAMPLE DOOR 11 1/2" X 20"
SDIC-3 AGUA MARINA M	CATALINA AGUA MARINA MATTE SAMPLE DOOR 11 1/2" X 20"
SDIC-3 ANTRACITA M	CATALINA ANTRACITA MATTE SAMPLE DOOR 11 1/2" X 20"
SDIC-3 AZUL INDIGO M	CATALINA AZUL INDIGO MATTE SAMPLE DOOR 11 1/2" X 20"
SDIC-3 AZUL MARINO M	CATALINA AZUL MARINO MATTE SAMPLE DOOR 11 1/2" X 20"
SDIC-3 BASALTO M	CATALINA BASALTO MATTE SAMPLE DOOR 11 1/2" X 20"
SDIC-3 BLACK M	CATALINA BLACK MATTE SAMPLE DOOR 11 1/2" X 20"
SDIC-3 BLANCO M	CATALINA BLANCO MATTE SAMPLE DOOR 11 1/2" X 20"
SDIC-3 CASHMERE M	CATALINA CASHMERE MATTE SAMPLE DOOR 11 1/2" X 20"
SDIC-3 GRIS PLOMO M	CATALINA GRIS PLOMO MATTE SAMPLE DOOR 11 1/2" X 20"
SDIC-3 VERDE SALVIA M	CATALINA VERDE SALVIA MATTE SAMPLE DOOR 11 1/2" X 20"

Pricing Note: Sales Tools are NET pricing; virtual multiplier applies to these items. Final price listed on Quote/Order will reflect the virtual multiplier.

Sample Doors

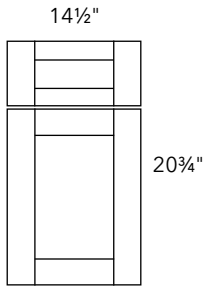

TUSCANY MEDIUM DOOR SAMPLES WITH DRAWER FRONT

ITEM	DESCRIPTION
SDIT-3 COMO ASH 1	TUSCANY COMO ASH 1 SAMPLE DOOR 11 1/2" X 20"
SDIT-3 COMO ASH 2	TUSCANY COMO ASH 2 SAMPLE DOOR 11 1/2" X 20"
SDIT-3 FRAPPE 1	TUSCANY FRAPPE 1 SAMPLE DOOR 11 1/2" X 20"
SDIT-3 IDA 1	TUSCANY IDA 1 SAMPLE DOOR 11 1/2" X 20"
SDIT-3 IDA 2	TUSCANY IDA 2 SAMPLE DOOR 11 1/2" X 20"
SDIT-3 MURATTI 1	TUSCANY MURATTI 1 SAMPLE DOOR 11 1/2" X 20"
SDIT-3 MURATTI 4	TUSCANY MURATTI 4 SAMPLE DOOR 11 1/2" X 20"
SDIT-3 NOCCE 1	TUSCANY NOCCE 1 SAMPLE DOOR 11 1/2" X 20"
SDIT-3 NOCCE 3	TUSCANY NOCCE 3 SAMPLE DOOR 11 1/2" X 20"
SDIT-3 OLMO 3	TUSCANY OLMO 3 SAMPLE DOOR 11 1/2" X 20"
SDIT-3 ROSALES 2	TUSCANY ROSALES 2 SAMPLE DOOR 11 1/2" X 20"
SDIT-3 ROSALES 3	TUSCANY ROSALES 3 SAMPLE DOOR 11 1/2" X 20"
SDIT-3 WOODLINE 1	TUSCANY WOODLINE 1 SAMPLE DOOR 11 1/2" X 20"
SDIT-3 WOODLINE 3	TUSCANY WOODLINE 3 SAMPLE DOOR 11 1/2" X 20"
SDIT-3 ANTRACITA M	TUSCANY ANTRACITA MATTE SAMPLE DOOR 11 1/2" X 20"
SDIT-3 AZUL INDIGO M	TUSCANY AZUL INDIGO MATTE SAMPLE DOOR 11 1/2" X 20"
SDIT-3 AZUL MARINO M	TUSCANY AZUL MARINO MATTE SAMPLE DOOR 11 1/2" X 20"
SDIT-3 BASALTO M	TUSCANY BASALTO MATTE SAMPLE DOOR 11 1/2" X 20"
SDIT-3 BLANCO M	TUSCANY BLANCO MATTE SAMPLE DOOR 11 1/2" X 20"
SDIT-3 CASHMERE M	TUSCANY CASHMERE MATTE SAMPLE DOOR 11 1/2" X 20"
SDIT-3 VERDE SALVIA M	TUSCANY VERDE SALVIA MATTE SAMPLE DOOR 11 1/2" X 20"

Pricing Note: Sales Tools are NET pricing; virtual multiplier applies to these items. Final price listed on Quote/Order will reflect the virtual multiplier.

Sales Tools



OVELA MINI BASE SAMPLE

ITEM	DESCRIPTION
OCBG MBS	Ovela Catalina Bianco Gloss Mini Base Sample

- Available in Catalina Bianco Gloss only
- Mini Base Dimensions: 12"W x 21"H x 15"D



SAMPLE DOOR BAG

ITEM	DESCRIPTION
SAMPLE DOOR BAG	PADDED SAMPLE DOOR BAG

- Accommodates 4 large sample doors



Shown with SD

SAMPLE DOOR STAND

ITEM	DESCRIPTION
SAMPLE DOOR STAND	SAMPLE DOOR DISPLAY STAND

- Stand can be easily unassembled and re-assembled for storage or portability to trade shows
- Sample Door Display stand can hold up to nine sample doors
- Will accommodate sizing for all door styles



Shown with SD-2

Pricing Note: Sales Tools are NET pricing; virtual multiplier applies to these items. Final price listed on Quote/Order will reflect the virtual multiplier.

Sales Tools



SELLING STUDIO

ITEM	DESCRIPTION
DEALER SELLING STUDIO	FABUWOOD SELLING STUDIO

Fabuwood Selling Studio Display includes:

- Interactive Touch Monitor
- 32 Medium-Size Sample Doors
- 18 Mini Sample Doors
- Molding Chains in Allure & Quest
- Color Block Sets for Signature, Designer Collection & Ovela
- Style Guide Brochures (Pack of 25)
- Wall and Base Mini Cabinets in Ovela and Allure Constructions
- Fabuwood Logo Windows
- Remote Control Operated Lift-Up Top Door
- Storage Drawer

Custom Base Cabinets:

- (1) 18" Drawer Base Cabinet with a modified depth of 18"
- (2) 18" Base Cabinet with a modified depth of 18"



COLOR BLOCKS

ITEM	DESCRIPTION
OVELA COLOR BLOCK	BOX OF COLOR BLOCKS FOR OVELA
CS-BIANCO GLOSS	BIANCO GLOSS LOOSE COLOR BLOCK
CS-BIANCO MATTE	BIANCO MATTE LOOSE COLOR BLOCK
CS-GRIGIO GLOSS	GRIGIO GLOSS LOOSE COLOR BLOCK
CS-CARBONE MATTE	CARBONE MATTE LOOSE COLOR BLOCK

Ovela Color Block:

- Set of 4 Ovela Color Blocks: Bianco Matte, Bianco Gloss, Carbone Matte, Grigio Gloss



SAMPLE PACKAGES

ITEM	DESCRIPTION
SMALL SAMPLE PACKAGE	SMALL SAMPLE PACKAGE
DEALER PACKAGE	LITERATURE AND ACCESSORIES

Small Sample Package:

- Full Set of Small Sample Doors (door is 11-1/2" x 14"H)

Dealer Package:

- Full set of Large Sample Doors (includes Door & Drawer Front)
- One of each molding chain for Allure, Quest
- Box of Color Blocks
- Digital Brochure Keychains (Pack of 25)

Pricing Note: Sales Tools are NET pricing; virtual multiplier applies to these items. Final price listed on Quote/Order will reflect the virtual multiplier.

Sales Tools



DIGITAL BROCHURE

ITEM	DESCRIPTION
DIGITAL BROCHURE QR	QR CODE KEY RING

- Pack of 25 Key Rings

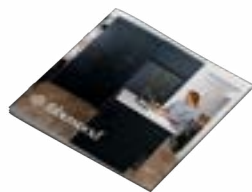

STYLE GUIDE

ITEM	DESCRIPTION
SG25	STYLE GUIDE BROCHURE 2025 (25PK)

- 80 pages, 8" x 8"
- Fabuwood's Style Guide showcases an extensive range of customizations and design possibilities. Featuring hoods, vanities, door styles, color collections, and more, it offers everything needed to create unique and personalized spaces



ACCESSORY BROCHURE

ITEM	DESCRIPTION
ACCESSORY BROCHURE	ACCESSORY BROCHURE (PACK OF 25)

- 28 pages, 8-1/2" x 11"
- Fabuwood's Accessory Brochure showcases a variety of stylish and practical add-ons, from organization features to innovative storage solutions, providing the finishing touches that enhance both the beauty and functionality of your cabinetry.



CUSTOMIZATION BROCHURE

ITEM	DESCRIPTION
CUSTOMIZATION BROCHURE	CUSTOMIZATION BROCHURE (PACK OF 25)

- 50 pages, 8-1/2" x 11"
- Fabuwood's Customization Brochure highlights a variety of modification options, enabling you to adjust every detail of your cabinetry.

Pricing Note: Sales Tools are NET pricing; virtual multiplier applies to these items. Final price listed on Quote/Order will reflect the virtual multiplier.

Modifications

CUT ITEMS

ITEM	DESCRIPTION
* CUT WIDTH-BASE	reduce width of base cabinet to ----- "wide
* CUT WIDTH-TALL	reduce width of tall cabinet to ----- "wide
* CUT WIDTH-WALL	reduce width of wall cabinet to ----- "wide
CUT-BASE	Reduce depth of base cabinet
CUT-COLUMN	reduce depth of column to ----- "deep
CUT-DBASE	Reduce depth of drawer base cabinet
* CUT-PANEL	Cut down a panel to any size
CUT-ROD	Reduce depth of rollout drawer
CUT-SBASE	Reduce depth of sink base cabinet
CUT-TALL	Reduce depth of tall cabinet
CUT-WALL	Reduce depth of wall cabinet
CUT-RETURN WIDTH	Reduce width of 3" reutr
CUT-BASE HEIGHT	Reduce height of base cabinet by removing top drawer
CUT 2" FROM 96" MOLDING	Reduce length of molding to 94"

* Not available for Ovela Designer Collection. Email customquotes@fabuwood.com for custom quote.

PIPE CHASE

ITEM	DESCRIPTION
CHASE-BASE	Make chase in base cabinet (must supply a drawing)
CHASE-CORNER	Make chase in corner cabinet ----- (WDC, WPC, ERB only)
CHASE-DBASE	Make chase in drawer cabinet (must supply drawing)
CHASE-TALL	Make chase in tall cabinet (must supply a drawing)
CHASE-WALL	Make chase in wall cabinet (must supply a drawing)

Must supply a drawing for all chase modifications.

Modifications

CUSTOMIZATIONS

ITEM	DESCRIPTION
HAMPER	Install door mounted pull out wood hamper in cabinet
INCREASE-BASE	Increase depth on base cabinet.
INCREASE-TALL	Increase depth on tall cabinet.
INCREASE-WALL	Increase depth on wall cabinet.
INSTALL-ACCES	Install any accessory in a cabinet (accessories not included)
PUSH TO OPEN DOORS	Install BLUM Tip-On Latch for push-to-open door(s)
PUSH TO OPEN DRAWERS	Install BLUM Tip-On Slides for push-to-open drawer(s)
REMOVE DRAWER	Remove cabinet drawer to create sink base
FINISHED END-BASE	Apply laminate skin to side of base cabinet
FINISHED END-WALL	Apply laminate skin to side of wall cabinet
FINISHED END-TALL	Apply laminate skin to side of tall cabinet
EBAND-MATCH BOX	Apply matching color edge-band to cabinet carcass
EBAND-MATCH SHELF	Apply matching color edge-band to adjustable shelves
CREATE-BMC	Create Base Microwave Cabinet
CREATE-BOC	Create Base Oven Cabinet
MATCH-INTERIOR	Finish interior of cabinet to match exterior
EXTENDED DOOR	Extend doors to overhang 1-1/2" or 3/4" below cabinet box
CONNECT DOORS	Connect doors of tall cabinet with dowels to create one larger door
EDGE BAND	Apply edge band on selected side of panel
INCREASE-PANEL	Increase depth of DWR in 1/4" increments.
FLUSH-TOE KICK	Flush toe kick of base cabinet to front of cabinet box

NOTE: Increased depth of Rollout drawers are by custom request only and are not included in INCREASE-BASE, INCREASE-TALL, and INCREASE-WALL modifications. Email customquotes@fabuwood.com for custom quote.

12" - 24" High Wall Cabinets

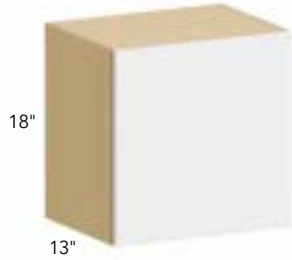

SINGLE DOOR

ITEM
W1218
W1518
W1818
W2118



DOUBLE DOOR

ITEM
W2412
W3012
W3312
W3612
W3015
W3315
W3615
W2718
W3018
W3318
W3618
W2421
W3021
W3321
W3621
* W3024
* W3324
* W3624

* Includes one adjustable shelf

12" - 24" High & 24" Deep Wall Cabinets



24" DEEP

ITEM
W301224
W331224
W361224
W301824
W331824
W361824
W302124
W332124
W362124
* W242424
* W302424
* W332424
* W362424

* Includes one adjustable shelf

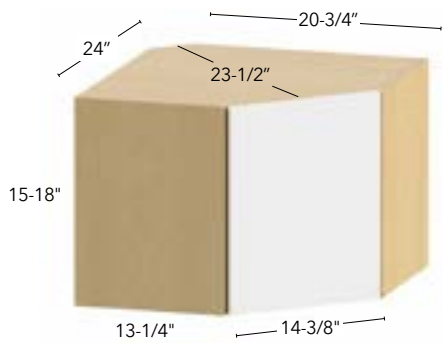

DIAGONAL CORNER

ITEM
WDC2415
WDC2418

Note: Need to indicate R or L at time of order

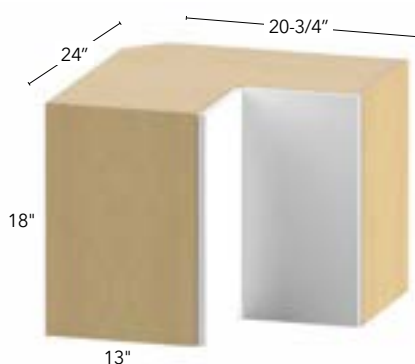

PIE CUT CORNER

ITEM
WPC2418

• Soft close hinge not available

Note: Need to indicate R or L at time of order

30" High Wall Cabinets

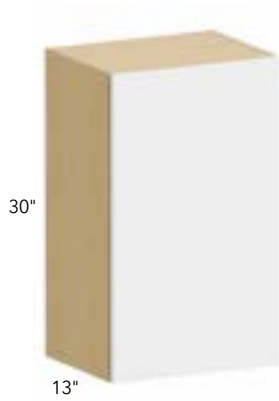

SINGLE DOOR

ITEM

W0930

W1230

W1530

W1830

W2130

W2430SD

- Includes two adjustable shelves

Note: Need to indicate R or L at time of order

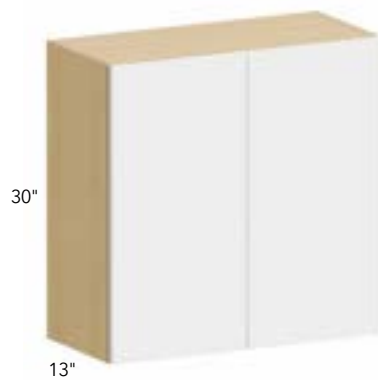

DOUBLE DOOR

ITEM

W2430

W2730

W3030

W3330

W3630

- Includes two adjustable shelves

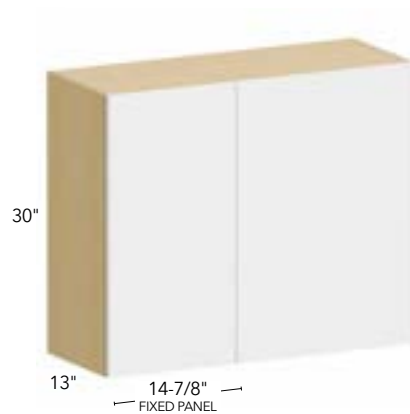

SINGLE DOOR BLIND

ITEM

WBC2730

WBC3030

WBC3630

- Must use filler on adjacent side (not supplied)
- Includes two adjustable shelves

Note: Need to indicate Blind Left or Blind Right at time of order

	Act.	Door	Open (door side)
WBC2730	27"	11-7/8"	11-1/4"
WBC3030	30"	14-7/8"	14-1/4"
WBC3630	36"	20-7/8"	20-3/16"

BLIND LEFT SHOWN

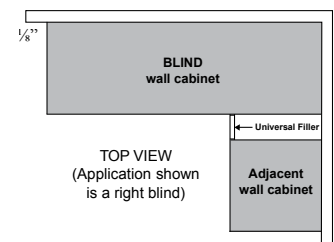

30" High Wall Cabinets

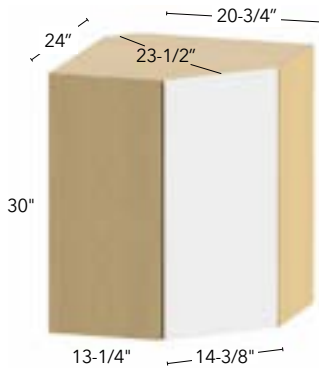

DIAGONAL CORNER

ITEM

WDC2430

- Includes two adjustable shelves
- Note: Need to indicate R or L at time of order*

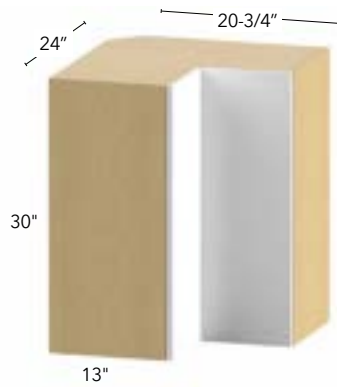

PIE CUT CORNER

ITEM

WPC2430

- Soft close hinge not available
 - Includes two adjustable shelves
- Note: Need to indicate R or L at time of order*

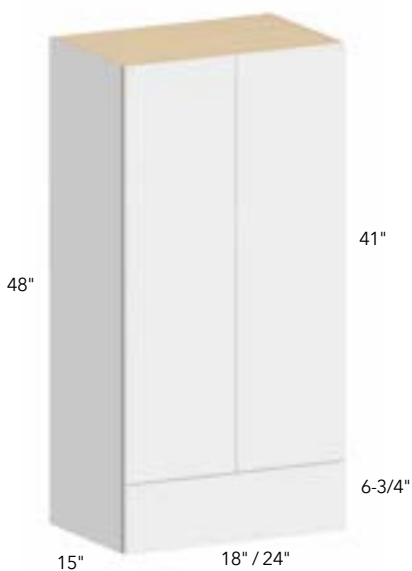

WALL WITH DRAWER

ITEM

* WD1848

WD2448

- * Has one door. Need to indicate R or L at time of order
- Includes two adjustable shelves

36" High Wall Cabinets

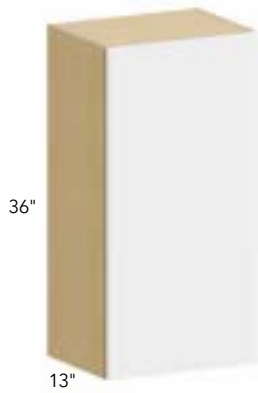

SINGLE DOOR

ITEM
W0936
W1236
W1536
W1836
W2136
W2436SD

- Includes two adjustable shelves
- Note: Need to indicate R or L at time of order*

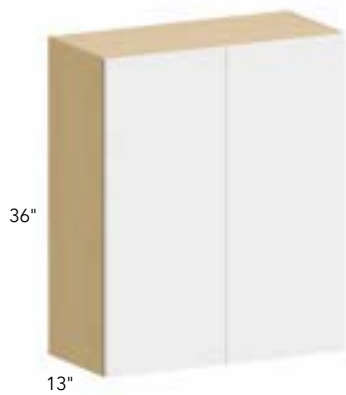

DOUBLE DOOR

ITEM
W2436
W2736
W3036
W3336
W3636

- Includes two adjustable shelves

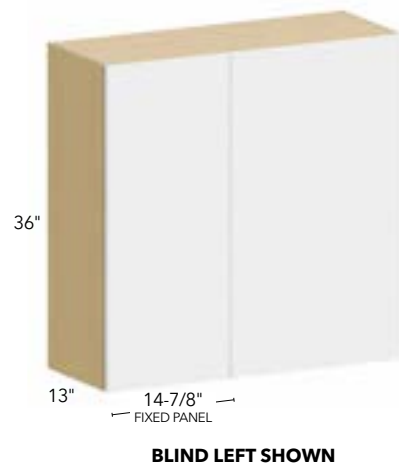

SINGLE DOOR BLIND

ITEM
WBC2736
WBC3036
WBC3636

- Must use filler on adjacent side (not supplied)
 - Includes two adjustable shelves
- Note: Need to indicate Blind Left or Blind Right at time of order*

	Act.	Door	Open (door side)
WBC2736	27"	11-7/8"	11-1/4"
WBC3036	30"	14-7/8"	14-1/4"
WBC3636	36"	20-7/8"	20-3/16"

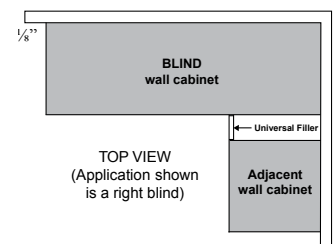

36" High Wall Cabinets

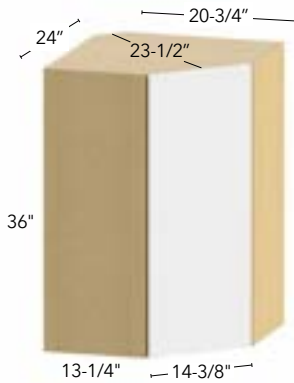

DIAGONAL CORNER

ITEM

WDC2436

- Includes two adjustable shelves
- Note:** Need to indicate R or L at time of order

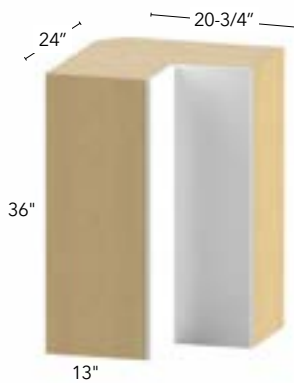

PIE CUT CORNER

ITEM

WPC2436

- Soft close hinge not available
 - Includes two adjustable shelves
- Note:** Need to indicate R or L at time of order

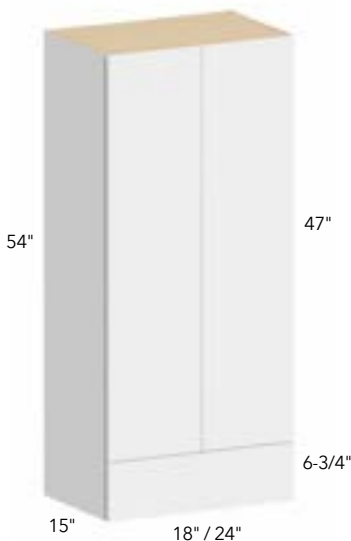

WALL WITH DRAWER

ITEM

* WD1854

WD2454

- * Has one door. Need to indicate R or L at time of order
- Includes two adjustable shelves

39" High Wall Cabinets

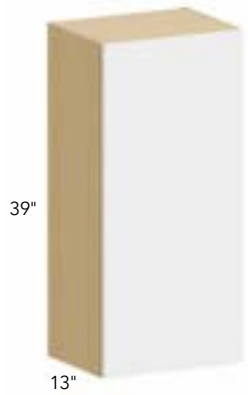

SINGLE DOOR

ITEM
W0939
W1239
W1539
W1839
W2139
W2439SD

- Includes two adjustable shelves

Note: Need to indicate R or L at time of order



DOUBLE DOOR

ITEM
W2439
W2739
W3039
W3339
W3639

- Includes two adjustable shelves

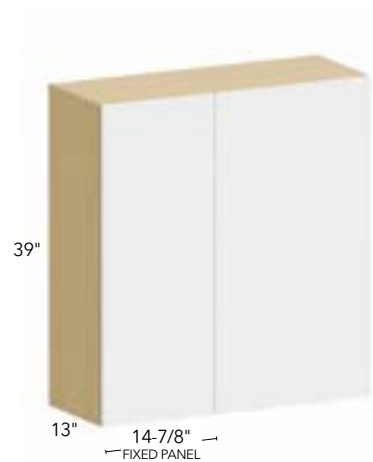

SINGLE DOOR BLIND

ITEM
WBC2739
WBC3039
WBC3639

- Must use filler on adjacent side (not supplied)
- Includes two adjustable shelves

Note: Need to indicate Blind Left or Blind Right at time of order

	Act.	Door	Open (door side)
WBC2739	27"	11-7/8"	11-1/4"
WBC3039	30"	14-7/8"	14-1/4"
WBC3639	36"	20-7/8"	20-3/16"

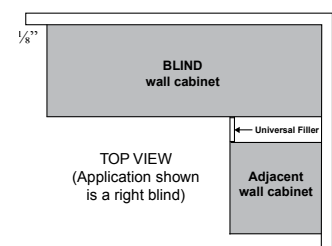

39" High Wall Cabinets

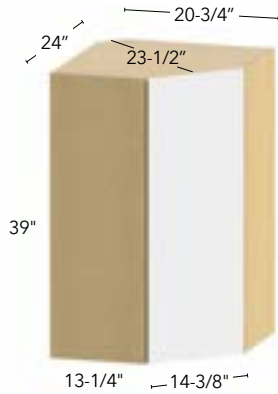

DIAGONAL CORNER

ITEM

WDC2439

- Includes two adjustable shelves
- Note:** Need to indicate R or L at time of order

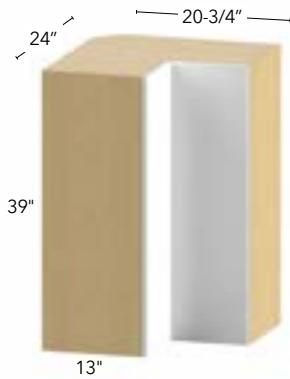

PIE CUT CORNER

ITEM

WPC2439

- Soft close hinge not available
 - Includes two adjustable shelves
- Note:** Need to indicate R or L at time of order

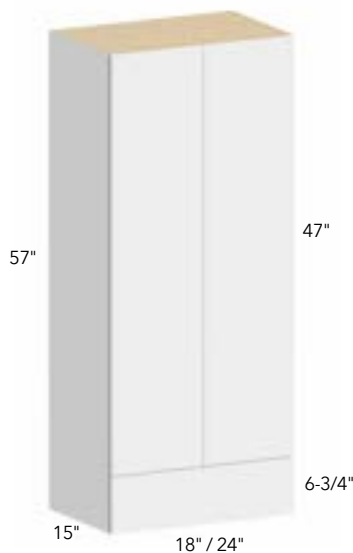

WALL WITH DRAWER

ITEM

* WD1857

WD2457

- * Has one door. Need to indicate R or L at time of order
- Includes two adjustable shelves

42" High Wall Cabinets

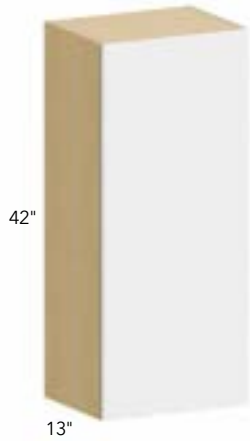

SINGLE DOOR

ITEM
W0942
W1242
W1542
W1842
W2142
W2442SD

- Includes three adjustable shelves

Note: Need to indicate R or L at time of order

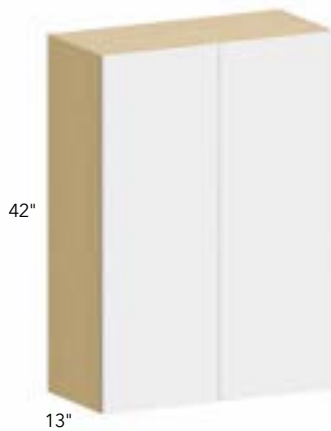

DOUBLE DOOR

ITEM
W2442
W2742
W3042
W3342
W3642

- Includes three adjustable shelves



SINGLE DOOR BLIND

ITEM
WBC2742
WBC3042
WBC3642

- Must use filler on adjacent side (not supplied)
- Includes three adjustable shelves

Note: Need to indicate Blind Left or Blind Right at time of order

	Act.	Door	Open (door side)
WBC2742	27"	11-7/8"	11-1/4"
WBC3042	30"	14-7/8"	14-1/4"
WBC3642	36"	20-7/8"	20-3/16"

BLIND LEFT SHOWN

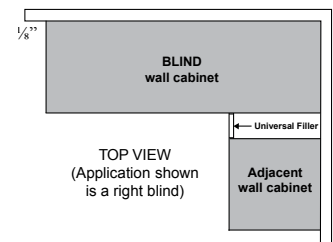

42" High Wall Cabinets

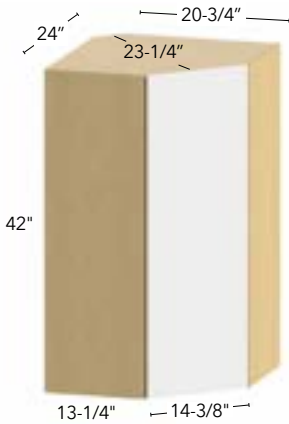

DIAGONAL CORNER

ITEM
WDC2442

- Includes three adjustable shelves

Note: Need to indicate R or L at time of order

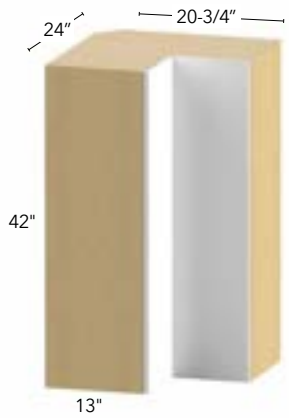

PIE CUT CORNER

ITEM
WPC2442

- Soft close hinge not available
- Includes three adjustable shelves

Note: Need to indicate R or L at time of order

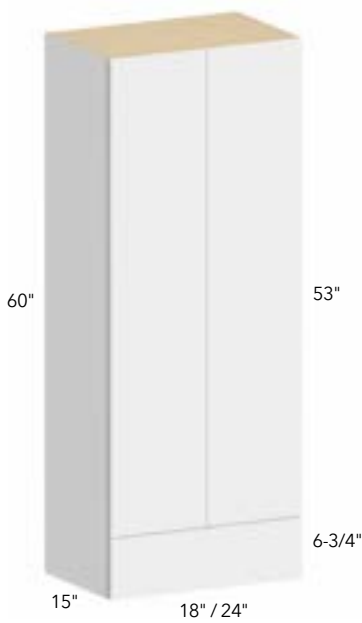

WALL WITH DRAWER

ITEM
* WD1860
WD2460

- * Has one door. Need to indicate R or L at time of order

- Includes three adjustable shelves

Specialty Wall Cabinets



WALL APPLIANCE

ITEM
WAC2418
WAC3018
WAC3318
WAC3618

- Shipped with a support bracket to be removed before cabinet installation



LIFT-UP

ITEM
* W2412LU
W1815LU
W2115LU
W2415LU
W2715LU
W3015LU
W3315LU
W3615LU
W1818LU
W2118LU
W2418LU
W2718LU
W3018LU
W3318LU
W3618LU
* W421224LU
* W481224LU

- * 24" depth



Microwave Wall Cabinets

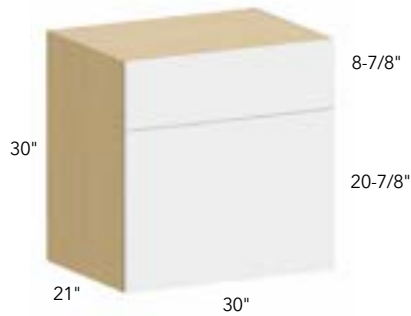

30" MICROWAVE

ITEM

MC303021

- Full closed front:
Max opening 28-1/2"W x 19-3/4"H
- Lift-up door with standard clip-on hinges
- Front panel attaches with clips for easy removal and install

Note: To avoid damage please apply extra care when cutting the front panel.

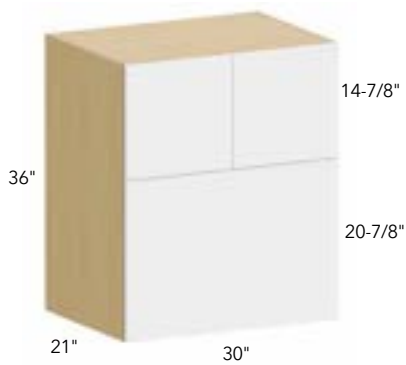

36" MICROWAVE

ITEM

MC303621

- Full closed front:
Max opening 28-1/2"W x 19-3/4"H
- Front panel attaches with clips for easy removal and install

Note: To avoid damage please apply extra care when cutting the front panel.

Microwave Wall Cabinets

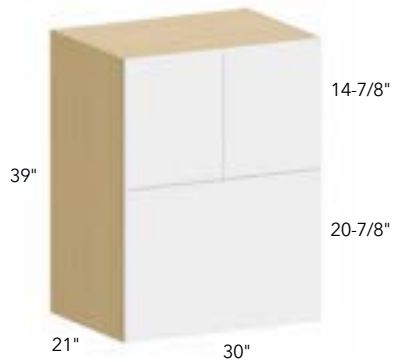

39" MICROWAVE

ITEM

MC303921

- Full closed front:
Max opening 28-1/2"W x 19-3/4"H
- Front panel attaches with clips for easy removal and install

Note: To avoid damage please apply extra care when cutting the front panel.

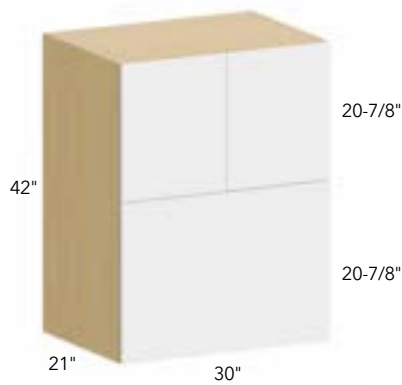

42" MICROWAVE

ITEM

MC304221

- Comes with 1 shelf
- Full closed front:
Max opening 28-1/2"W x 19-3/4"H
- Front panel attaches with clips for easy removal and install

Note: To avoid damage please apply extra care when cutting the front panel.

Wine Cabinets

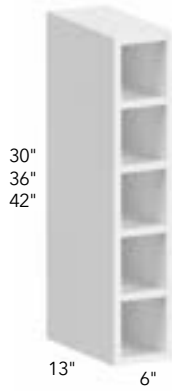

WINE CUBE

ITEM

WC0630

WC0636

WC0642

- Matching finished interior
- Gloss finishes are featured on top of shelves and all interior faces of the cabinet box
- 30" Fits 5 bottles
- 36" Fits 6 bottles
- 42" Fits 7 bottles

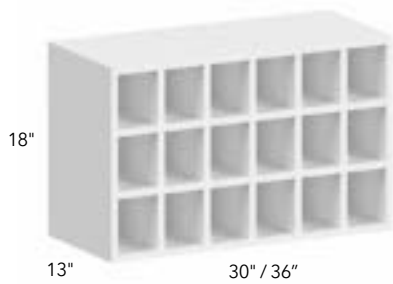

WINE RACK

ITEM

WR3018

WR3618

- Matching finished interior
- Gloss finishes are featured on top of shelves and all interior faces of the cabinet box
- 30" Fits 18 bottles
- 36" Fits 21 bottles

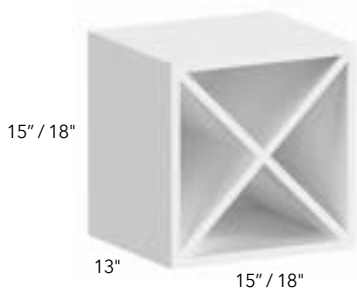

WINE RACK

ITEM

WR15X15

WR18X18

- Matching finished interior
- Gloss finishes are featured on top of shelves and all interior faces of the cabinet box
- Storage Capacity
 - » WR15X15: 8-12 bottles
 - » WR18X18: 12-16 bottles

Base Cabinets



FULL HEIGHT SINGLE DOOR

ITEM
B09FD
B12FD
B15FD
B18FD
B21FD
B24SFD

- Includes two 18" deep adjustable shelves

Note: Need to indicate R or L at time of order



FULL HEIGHT DOUBLE DOOR

ITEM
B24FD
B27FD
B30FD
B33FD
B36FD

- Includes two 18" deep adjustable shelves

Base Cabinets



SINGLE DOOR

ITEM

B12

B15

B18

B21

B24SD

- Includes one 18" deep adjustable shelf
- Note: Need to indicate R or L at time of order*



DOUBLE DOOR

ITEM

B24

B27

B30

B33

B36

- Includes one 18" deep adjustable shelf

Drawer Base Cabinets



2 DRAWER

ITEM
DB24-2
DB27-2
DB30-2
DB33-2
DB36-2



3 DRAWER

ITEM
DB12-3
DB15-3
DB18-3
DB21-3
DB24-3
DB27-3
DB30-3
DB33-3
DB36-3



4 DRAWER

ITEM
DB12-4
DB15-4
DB18-4
DB21-4

Blind Base Cabinets

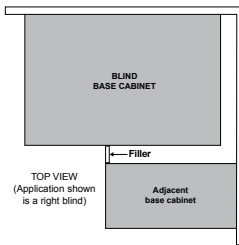
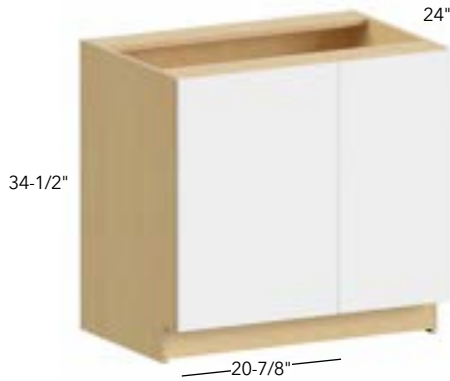

BLIND FULL HEIGHT DOOR

ITEM

BLB36/39FD

BLB39/42FD

BLB42/45FD

BLB48/51FD

- Must use filler on adjacent wall (not supplied)
- Includes two 18" deep adjustable shelves

Note: Need to indicate Blind Left or Blind Right at time of order

	Act.	Min.	Door	Closed Blind	Open (Door)
BLB36/39FD	30"	36"	8-7/8"	20-7/8"	8-11/32"
BLB39/42FD	33"	39"	11-7/8"	20-7/8"	11-11/32"
BLB42/45FD	36"	42"	14-7/8"	20-7/8"	14-11/32"
BLB48/51FD	42"	48"	20-7/8"	20-7/8"	20-11/32"

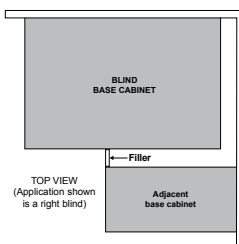

BLIND

ITEM

BLB36/39

BLB39/42

BLB42/45

BLB48/51

- Includes one 18" deep adjustable shelf
- Must use filler on adjacent wall (not supplied)

Note: Need to indicate Blind Left or Blind Right at time of order

	Act.	Min.	Door	Closed Blind	Open (Door)	Open (Drawer)
BLB36/39	30"	36"	8-7/8"	20-7/8"	8-11/32"	7 5/8"
BLB39/42	33"	39"	11-7/8"	20-7/8"	11-11/32"	10 5/8"
BLB42/45	36"	42"	14-7/8"	20-7/8"	14-11/32"	13 5/8"
BLB48/51	42"	48"	20-7/8"	20-7/8"	20-11/32"	19 5/8"

Corner Base Cabinets

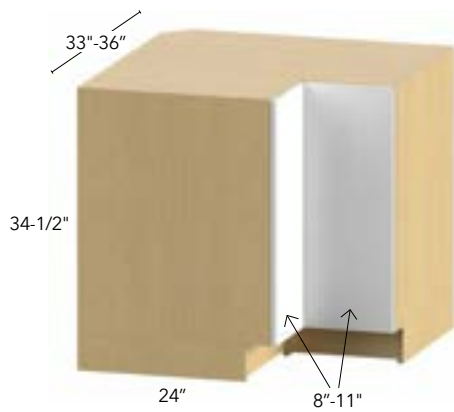

EASY REACH

ITEM

ERB33

ERB36

- Center shelf is adjustable
- Soft close hinge not available
- Two 4-1/2" H platforms are provided separately for installation on site.

Note: Need to indicate R or L at time of order

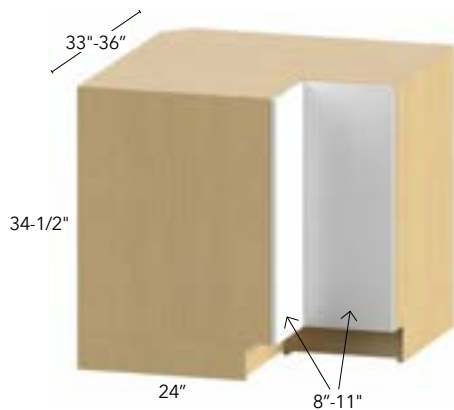

LAZY SUSAN

ITEM

LSB33

LSB36

- LSB33: Includes two 26" Pie-Cut Lazy Susan Trays
- LSB36: Includes two 32" Pie-Cut Lazy Susan Trays
- Both Lazy Susan trays rotate independently
- Center tray is mounted on a 3/4" adjustable shelf
- Soft close hinge not available
- Two 4-1/2" H platforms are provided separately for installation on site.

Note: Need to indicate R or L at time of order

Sink Base Cabinets

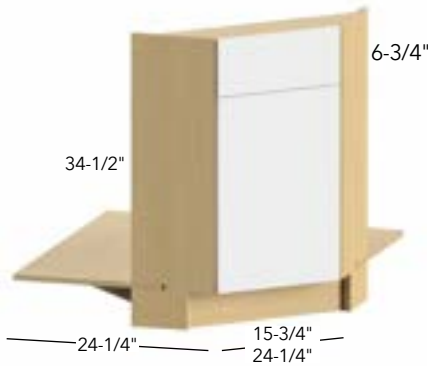

DIAGONAL SINK FRONT

ITEM

DSF36

DSF42*

DSF36FD

DSF42FD*

- DSF36(FD): One Door - 15-3/4"W
- DSF42(FD): Two Doors - 12-1/16"W
- * **Note: Need to indicate R or L at time of order**



SINK BASE

ITEM

* SB21

* SB24SD

SB24

SB27

SB30

SB33

SB36

- * Single door cabinet. Need to indicate R or L at time of order
- Note: Sink Base cabinets come pre-drilled with shelf clip holes
Loose shelves available to purchase separately.



FARM SINK

ITEM

FS30

FS33

FS36

- Cut opening on job site
- Farm Sink Base comes with Apron Panel front
- Max opening:
FS30: 28-1/2"W x 11-5/8"H
FS33: 31-1/2" x 11-5/8"H
FS36: 34-1/2"W x 11-5/8"H
- Front panel attaches with clips for easy removal and install
- Note: To avoid damage please apply extra care when cutting the front panel.**

Specialty Base Cabinets



MICROWAVE

ITEM

BMC24

BMC30

- Front panel attaches with clips for easy removal and install
- Max opening:
BMC24: 22-1/2"W x 19-3/4"H
BMC30: 28-1/2"W x 19-3/4"H
- Additional Edge-Band available for purchase

Note: To avoid damage, please apply extra care when cutting the front panel.



OVEN

ITEM

BOC30

- Front panel attaches with clips for easy removal and install
- Max opening: 28-1/2"W x 28-1/2"H

Note: To avoid damage, please apply extra care when cutting the front panel.



RANGE TOP BASE

ITEM

RTB30

RTB36

RTB48

- Includes one adjustable shelf
- Range Top Bases come with full top panel



RANGE TOP DRAWER BASE

ITEM

RTDB30-2

RTDB36-2

RTDB48-2

- Range Top Bases come with full top panel

13" Deep Tall Pantry Cabinets

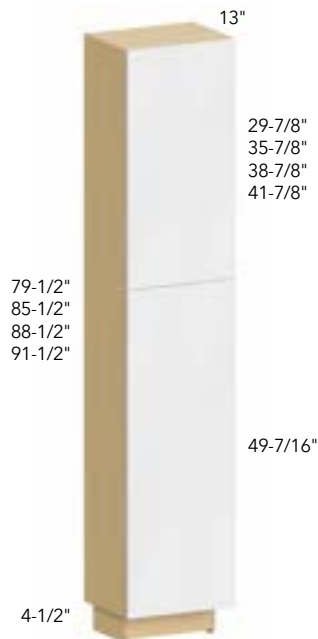

SINGLE DOOR 13" DEEP

ITEM
TP151384
TP181384
TP241384SD
TP151390
TP181390
TP241390SD
TP151393
TP181393
TP241393SD
TP151396
TP181396
TP241396SD

- Includes 12-1/4" deep shelves
 - » 84/90"H: 5 shelves
 - » 96"H: 6 shelves
- 4-1/2" H platform is shipped separately. Platform may be installed left or right to create a recessed toe kick at cabinet side.

Note: Need to indicate R or L at time of order

Shipping Note: Pantry shelves ship loose and will appear as individual line items on order packing list. Additional charges or pallet requirements may result depending on shipping method.

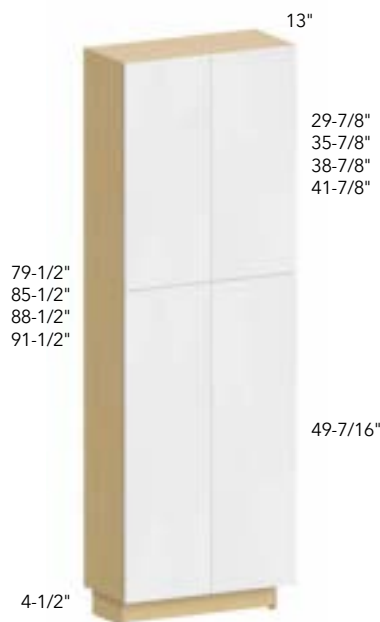

DOUBLE DOOR 13" DEEP

ITEM
TP241384
TP241390
TP241393
TP241396
TP301384
TP301390
TP301393
TP301396

- Includes 12-1/4" deep shelves
 - » 84/90"H: 5 shelves
 - » 96"H: 6 shelves
- 4-1/2" H platform is shipped separately. Platform may be installed left or right to create a recessed toe kick at cabinet side.

Shipping Note: Pantry shelves ship loose and will appear as individual line items on order packing list. Additional charges or pallet requirements may result depending on shipping method.

24" Deep Tall Pantry Cabinets

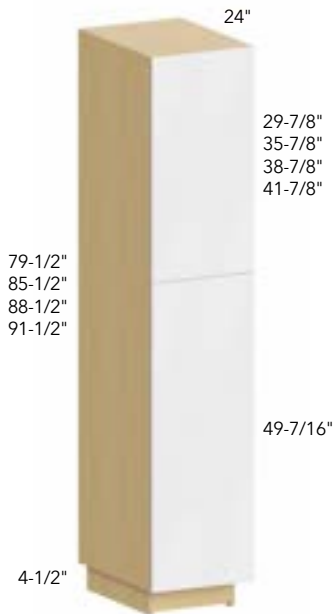

SINGLE DOOR

ITEM
TP152484
TP182484
TP242484SD
TP152490
TP182490
TP242490SD
TP152493
TP182493
TP242493SD
TP152496
TP182496
TP242496SD

- Includes 12-1/4" deep shelves
 - » 84/90"H: 5 shelves
 - » 96"H: 6 shelves
- 4-1/2" H platform is shipped separately. Platform may be installed left or right to create a recessed toe kick at cabinet side.

Note: Need to indicate R or L at time of order

Shipping Note: Pantry shelves ship loose and will appear as individual line items on order packing list. Additional charges or pallet requirements may result depending on shipping method.

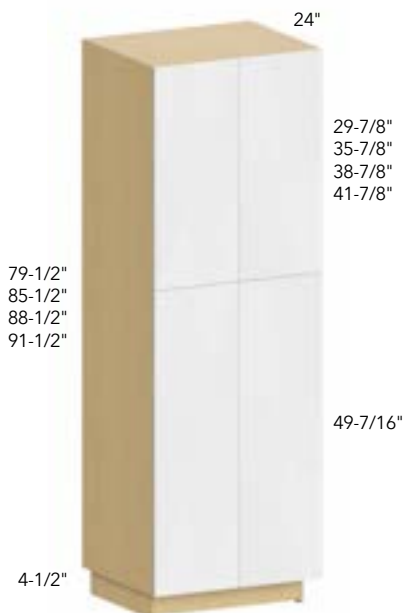

DOUBLE DOOR

ITEM
TP242484
TP242490
TP242493
TP242496
TP302484
TP302490
TP302493
TP302496

- Includes 12-1/4" deep shelves
 - » 84/90"H: 5 shelves
 - » 96"H: 6 shelves
- 4-1/2" H platform is shipped separately. Platform may be installed left or right to create a recessed toe kick at cabinet side.

Shipping Note: Pantry shelves ship loose and will appear as individual line items on order packing list. Additional charges or pallet requirements may result depending on shipping method.

Oven Cabinets

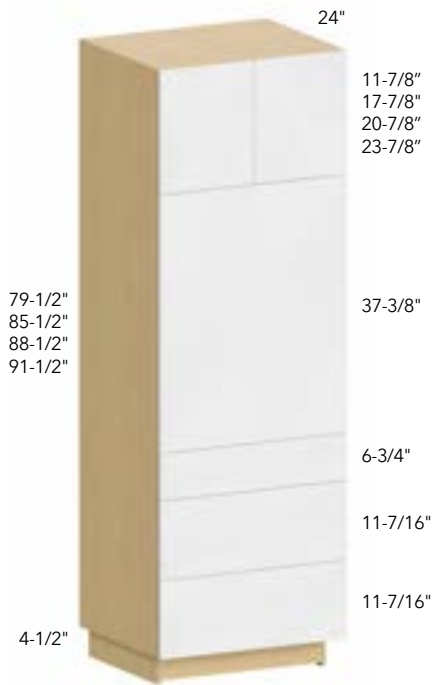

SINGLE OVEN CABINET W/ 3 DRAWERS ON THE BOTTOM

ITEM
OC2484S-3
OC3084S-3
OC2490S-3
OC3090S-3
OC2493S-3
OC3093S-3
* OC2496S-3
* OC3096S-3

* Includes one shelf in upper wall section.

- 4-1/2" H platform is shipped separately. Platform may be installed left or right to create a recessed toe kick at cabinet side.

When using two appliances:

It is recommended to provide support for top appliance; PLY-3/4 available to be purchased separately. Fixed shelf to be installed on the jobsite by a qualified installer.

Full panel face frame to be trimmed on site (not by Fabuwood).

Note: To avoid damage to the frame & side panels, please apply extra care when cutting the front panel.

Oven Cabinets



COMBO OVEN CABINET W/ 2 DRAWERS ON BOTTOM

ITEM
OC2484C
OC3084C
OC2490C
OC3090C
OC2493C
OC3093C
* OC2496C
* OC3096C

* Includes one shelf in upper wall section.

- 4-1/2" H platform is shipped separately. Platform may be installed left or right to create a recessed toe kick at cabinet side.

When using two appliances:

It is recommended to provide support for top appliance; PLY-3/4 available to be purchased separately. Fixed shelf to be installed on the jobsite by a qualified installer.

Full panel face frame to be trimmed on site (not by Fabuwood).

Note: To avoid damage to the frame & side panels, please apply extra care when cutting the front panel.

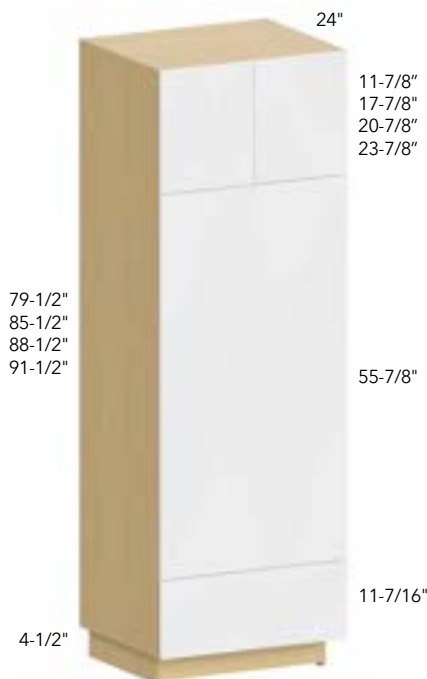

DOUBLE OVEN CABINET W/ 1 DRAWER ON BOTTOM

ITEM
OC2484D
OC3084D
OC2490D
OC3090D
OC2493D
OC3093D
* OC2496D
* OC3096D

* Includes one shelf in upper wall section.

- 4-1/2" H platform is shipped separately. Platform may be installed left or right to create a recessed toe kick at cabinet side.

When using two appliances:

It is recommended to provide support for top appliance; PLY-3/4 available to be purchased separately. Fixed shelf to be installed on the jobsite by a qualified installer.

Full panel face frame to be trimmed on site (not by Fabuwood).

Note: To avoid damage to the frame & side panels, please apply extra care when cutting the front panel.

Vanities



SINGLE DOOR VANITY BASE

ITEM
VB12
VB15
VB18
VB21

- Includes one 18" deep adjustable shelf
- Note: Need to indicate R or L at time of order*



VANITY BASE

ITEM
VB24
VB27
VB30
VB33
VB36

- Includes one 18" deep adjustable shelf



VANITY DRAWER BASE (3 DRAWERS)

ITEM
VDB12
VDB15
VDB18

Vanities



VANITY SINK BASE (FULL HEIGHT SINGLE DOOR)

ITEM
VSB24SFD

Note: Sink Base cabinets come pre-drilled with shelf clip holes. Loose shelves available to purchase separately.



VANITY SINK BASE (SINGLE DOOR WITH DRAWER)

ITEM
VSB24SD

Note: Sink Base cabinets come pre-drilled with shelf clip holes. Loose shelves available to purchase separately.

Vanities



VANITY SINK BASE (SAME LOOK AS 2 DOOR/DRAWER BASE)

ITEM
VSB24
VSB27
VSB30
VSB33
VSB36

Note: Sink Base cabinets come pre-drilled with shelf clip holes. Loose shelves available to purchase separately.



VANITY SINK BASE (FULL HEIGHT 2 DOORS)

ITEM
VSB24FD
VSB27FD
VSB30FD
VSB33FD
VSB36FD

Note: Sink Base cabinets come pre-drilled with shelf clip holes. Loose shelves available to purchase separately.

Waste Solutions

OTC18 BLUM



OTC15 BLUM



TRASH CAN (BLUM SLIDES)

ITEM
* OTC15 BLUM
OTC18 BLUM
OTC21 BLUM
** OTCV15 BLUM

- Tandem plus Blumotion full extension concealed drawer runners
- Cabinet not included, cabinet must be ordered separately
- 2 - 35 qt. cans included
- * Single 35 qt. can + one bags bin
- ** Smaller depth for vanity cabinets

OTC18FHD BLUM



OTC15FHD BLUM



TRASH CAN FULL HEIGHT DOOR (BLUM SLIDES)

ITEM
* OTC15FHD BLUM
OTC18FHD BLUM
OTC21FHD BLUM

- Tandem plus Blumotion full extension concealed drawer runners
- Cabinet not included, cabinet must be ordered separately
- 2 - 50 qt. can included
- * Single 50 qt. can + one bags bin

Base Accessories



ROLL OUT DRAWER

ITEM
OROD-B15 BLUM H
OROD-B18 BLUM H
OROD-B21 BLUM H
OROD-B24 BLUM H
OROD-B27 BLUM H
OROD-B30 BLUM H
OROD-B33 BLUM H
OROD-B36 BLUM H

- Cabinet not included
- Price is for a single Roll Out drawer
- Blumotion full extension concealed drawer runners
- Drawers are adjustable
- Can be used for pantries



INTERIOR ROLL OUT FOR 2 DRAWER BASE

ITEM
OROD-DB24-2 BLUM H
OROD-DB27-2 BLUM H
OROD-DB30-2 BLUM H
OROD-DB33-2 BLUM H
OROD-DB36-2 BLUM H

- Available for 2 Drawer Base Cabinet Only
- Blumotion full extension concealed drawer runners

Note: Includes installation in top drawer only. Cabinet is not included.

Base Accessories

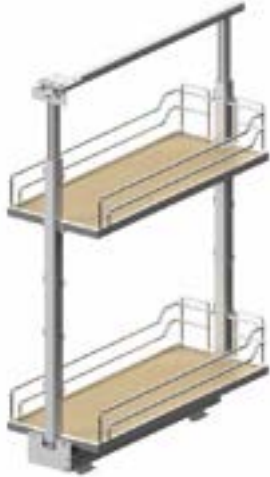

SPICE PULL OUT BASE

ITEM
OSPO-B9
OSPO-B12
OSPO-B15
OSPO-B18

- Cabinet not included, cabinet must be ordered separately
- Features Blumotion soft-close drawer slides
- Chrome rails
- Adjustable shelves
- UV coated maple wood



SPICE PULL OUT

ITEM
OSPO-B9 BLUM
OSPO-B12 BLUM

- Cabinet not included, cabinet must be ordered separately
- Features Blumotion soft-close drawer slides
- Chrome rails
- Adjustable shelves
- UV coated maple wood

Base Accessories



UTENSIL PULL OUT

ITEM

OUPO-B9 BLUM

OUPO-B12 BLUM

- Cabinet not included, cabinet must be ordered separately
- Chrome rails
- Adjustable shelves
- UV coated maple wood
- Features Blumotion soft-close drawer slides



UTENSIL & KNIFE PULL OUT

ITEM

OUKBPO-B12 BLUM

- Cabinet not included, cabinet must be ordered separately
- Designed for full height base cabinet
- Knife block features flex rod technology that adjust to securely hold knives
- Chrome rails
- Adjustable top shelf
- Includes one 2 qt. removeable stainless steel bin
- 4 flexible plastic cutting mats included
- UV coated maple wood
- Features Blumotion soft-close drawer slides



BPOBLB42/45-L



BPOBLB48/51-L

BLIND BASE PULL OUT

ITEM

BPO-BLB42/45-R

BPO-BLB42/45-L

BPO-BLB48/51-R

BPO-BLB48/51-L

- Cabinet not included
- Includes two trays per accessory
- Load Capacity:
 - » BPO-BLB42/45: 33lb (15kg) per tray
 - » BPO-BLB48/51: 55lb (25kg) per tray
- Maple/Champagne Finish

Base Accessories



TWO-TIER COOKWARE ORGANIZER

ITEM

CWO-B18 BLUM

CWO-B24 BLUM

- Cabinet not included
- Full-extension Blum slides
- Pegboard bottoms
- 4 Press-in pegs included



SPICE PULL OUT

ITEM

* SPO-BF3

SPO-BF3 BLUM

SPO-BF6 BLUM

- Filler & Overlay Filler are required and need to be ordered separately
- Chrome rails
- Adjustable shelves
- UV coated maple wood
- Installed on site between two cabinets
- Not for ADA cabinet use
- Wall filler 30" high is recommended instead of a base filler, requires to build toe kick separately
- * Full extension ball-bearing slides (not soft-close)



18" HEAVY DUTY MIXER LIFT

ITEM

OMLU-B18

- Cabinet not included; cabinet must be ordered separately
- Soft-close mechanism features built-in shock dampeners with adjustable spring tension
- Load Capacity: 60 lb (27kg)
- Silver Steel Mechanism with Maple Wood Block Shelf
- Shelf is 20"(L) x 11-3/4" (W) x 1-3/8" (H)

NOTE: For B18FD Only. Will not work in a door/drawer configuration.

Base Accessories



STEP STOOL PULL OUT

ITEM
SSPO-BF1-1/2

- *Required filler and optional overlay filler are not included and need to be ordered separately*



DOOR MOUNTED PULL OUT

ITEM
ODMPO-B12
ODMPO-B15
ODMPO-B18
ODMPO-B21
ODMPO-B09FD
ODMPO-B12FD
ODMPO-B15FD
ODMPO-B18FD
ODMPO-B21FD

- *Includes two adjustable trays (shipped loose)*

Note: Frame includes installation when ordered as an accessory on a cabinet. Cabinet is not included.

Base Accessories



YOUBOX PULL OUT

ITEM

OUBPO-B12

OUBPO-B15

OUBPO-B18

OUBPO-B12FD

OUBPO-B15FD

OUBPO-B18FD

- **Features:**
 - two 1L storage boxes with lids
 - two 2.1L storage boxes
 - one large divider
 - two traverse rails
- Includes two adjustable trays (shipped loose)

Note: Frame includes installation when ordered as an accessory on a cabinet. Cabinet is not included.



UTILITY & KNIFE PULL OUT

ITEM

OUKBPO-B12

OUKBPO-B15

OUKBPO-B18

OUKBPO-B12FD

OUKBPO-B15FD

OUKBPO-B18FD

- **Features:**
 - utility frame
 - four storage boxes
 - one knife block insert
- Includes two adjustable trays (shipped loose)

Note: Frame includes installation when ordered as an accessory on a cabinet. Cabinet is not included.



PAPER TOWEL PULL OUT

ITEM

OPTPO-B12

OPTPO-B09FD

OPTPO-B12FD

- **Features:**
 - paper towel holder frame
 - one 1L storage box
- Includes two adjustable trays (shipped loose)

Note: Frame includes installation when ordered as an accessory on a cabinet. Cabinet is not included.

Base Accessories



BAKER TRAY PULL OUT

ITEM

BTPO-B12 ILLUME

BTPO-B09FD ILLUME

BTPO-B12FD ILLUME

- *Features:*
 - one metal shelf
 - two wire racks
 - elastic bumpers
 - plastic clips

Note: Frame includes installation when ordered as an accessory on a cabinet. Cabinet is not included.



HPO-18



HPO-24

HAMPER PULL OUT

ITEM

HPO-18 ILLUME

HPO-24 ILLUME

- *Cabinet not included, cabinet must be ordered separately*
- *Includes two removable plastic hamper baskets*
- *Total Load Capacity: 100lb (50kg)*

Wall Accessories



SPICE PULLOUT WALL FILLER

ITEM

SPO-WF330

SPO-WF336

SPO-WF342

SPO-WF630

SPO-WF636

SPO-WF642

- Filler & Overlay Filler are required and need to be ordered separately
- Chrome rails
- Full extension ball-bearing slides (BLUM soft-close slides not available)
- Adjustable shelves
- UV coated maple wood
- Installed on site between two cabinets



LAZY SUSAN TWISTER

ITEM

OLSTS24 30

OLSTS24 36

OLSTS24 39/42

- OLSTS24 30: Includes two twister trays (shipped loose)
- OLSTS24 36/39/42: Includes three twister trays (shipped loose)

Note: Frame includes installation when ordered as an accessory on a cabinet. Cabinet is not included.



PULL DOWN SHELF

ITEM

PDS-W24 ILLUME

PDS-W36 ILLUME

- Cabinet not included, cabinet must be ordered separately
- Features two chrome wire shelves
- Gas-assisted lifting/lowering mechanism
- Pulls down 11-1/2" and out 16-3/4"
- Load Capacity: 17lb

NOTE: For 24/36"W x 30/36/42"H Wall Cabinets only.

Sink Accessories



TILT OUT

ITEM
TILTOUT 11"
TILTOUT 14"
TILTOUT 24"

- Includes installation when added to cabinet
- White plastic tray



SBPO1-21/36 ILLUME



SBPO3-21/36 ILLUME

SINK BASE PULL OUT

ITEM
SBPO1-21/36 ILLUME
SBPO3-21/36 ILLUME

- **SBPO1-21/36 ILLUME Features:**
 - one removable basket with handle
 - four dividers
- **SBPO3-21/36 ILLUME Features:**
 - one removable basket with handle
 - one basket without handle
 - one swivel basket
 - eight dividers

Note: Frame includes installation when ordered as an accessory on a cabinet. Cabinet is not included.

Appliance Accessories

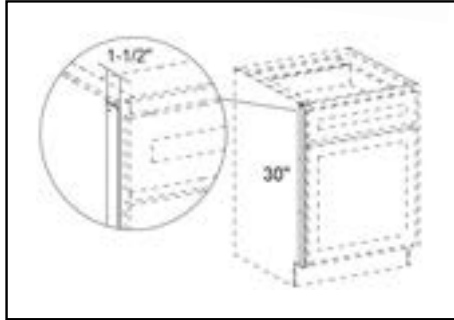

HEAT SHIELD

ITEM

HEAT SHIELD WHITE

- 1/16" thick powder-coated steel with pre-drilled installation holes.
- Recommended to shield the cabinet box from adjacent oven heat.
- Sold individually; must order quantity of 2.

NOTE: This item is required when installing cabinets on either side of a heating appliance (for example a Range). Fabuwood does not take responsibility for failure to order this item and will not warranty Ovela Cabinetry that has not been installed with the heat shield adjacent to a heating appliance.

Drawer Accessories



TRIMMABLE CUTLERY INSERT

ITEM
CD-S
CD-L

- UV coated maple wood
- 3/8" dividers
- 2-1/2" interior height
- 3/8" plywood bottom
- Includes installation

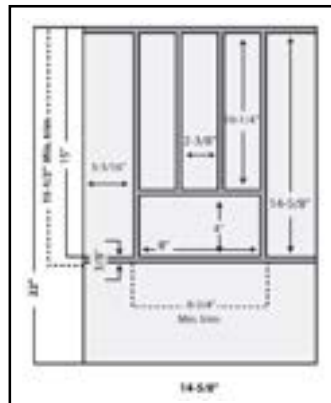

CD-S

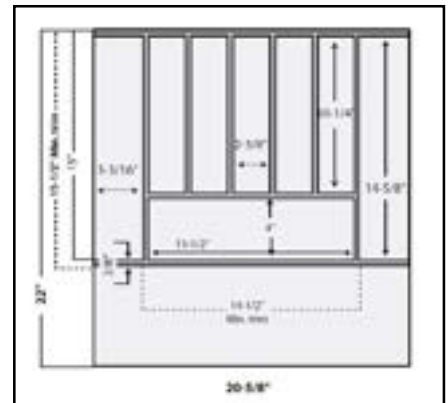

CD-L



WIDE TRIMMABLE CUTLERY INSERT

ITEM
CD-XL

- Designed for 36" or smaller base cabinet drawers
- UV coated maple wood
- 3/8" dividers
- 2-1/2" interior height
- 3/8" plywood bottom
- Includes installation

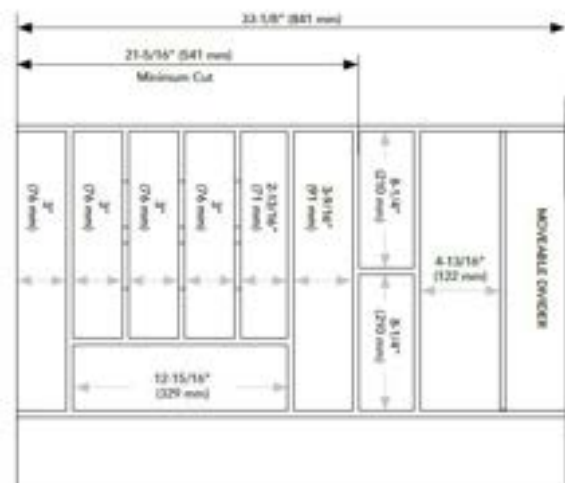

Drawer Accessories



DRAWER PEGBOARD SYSTEM

ITEM
DPS-18/27
DPS-30/33

- Compatible with Three Drawer Base Cabinets (middle and bottom drawers only) and Two Drawer Base Cabinets
- Boards are cut-to-size during assembly to fit drawer box (includes installation)
- Maple wood with semi-gloss finish
- Pre-drilled placement holes are 2-1/2" apart in both directions
- Available as loose accessory (to be trimmed on site)
- DPS-18/27:
 - » To fit 18" - 27" drawer
 - » Includes nine 6" tall adjustable peg inserts
- DPS-30/33:
 - » To fit 30" - 33" drawer
 - » Includes twelve 6" tall adjustable peg inserts

Drawer Accessories



TIERED DEEP DRAWER

ITEM

ODTD-DB30 BLUM

ODTD-DB36 BLUM

- For DB30 & DB36 only
- Replaces the original drawer box of cabinet
- UV coated maple wood
- Drawer front not included
- 3 drawer compartments
- Blumotion full extension concealed drawer runners



CHARGING DRAWER

ITEM

OCHD-B18 BLUM

- For 18" cabinet drawer only
- Replaces the original drawer box of cabinet
- UV coated maple wood
- Blumotion full extension concealed drawer runners
- (2) 120V plugs and (2) 201 amp USB ports
- Tamper resistant outlets
- Max current: AC: 12 amps @ 120VAC; USB 2.1 amp & 5 VDC
- Power cord with NEMA 5 - 15 plug
- Integrated cord guide to ensure safe operation
- Shock absorbent mat, black
- Overall safety of this product is determined by its end use

Drawer Accessories



2-TIER CUTLERY DRAWER

ITEM
ODCD-15 BLUM
ODCD-18 BLUM
ODCD-21 BLUM
ODCD-24 BLUM

- *UV coated maple wood*
- *Includes complete 3-3/4" high drawer box*
- *Features Blum soft-close slides*



2-TIER CUTLERY COMBO DRAWER

ITEM
ODCD-30 BLUM
ODCD-36 BLUM

- *UV coated maple wood*
- *Includes complete 3-3/4" high drawer box*
- *Features Blum soft-close slides*

Vanity Accessories



VANITY OUTLET GROOMING ORGANIZER

ITEM

VGO12FD BLUM

- Cabinet not included, cabinet must be ordered separately
- Designed for 12" full height cabinet
- 2 removable stainless steel bins included
- 2 shelves with non-skid vinyl lining and acrylic accents
- In-drawer receptacle with (2) 120V plugs
- Tamper-resistant outlets
- Max Current: AC: 12 amps @ 120VAC
- Power cord with NEMA 5 - 15 plug
- Integrated cord guide ensures safe operation
- Drawer stop prevents items from being stored "ON" inside the cabinet
- Its end-use determines the overall safety of this product
- UV coated maple wood
- Not for ADA cabinet use
- Blumotion full extension concealed drawer runners



TRIMMABLE VANITY DRAWER ORGANIZER INSERT

ITEM

VDO

- Designed for 21" or smaller vanity base drawers
- Fits perfectly for KD30 cabinet
- Anti-skid vinyl lining
- Up to 13 compartments
- 2 clear acrylic lids
- UV coated maple wood

Vanity Accessories



VANITY ORGANIZER PULL OUT

ITEM

VOPO-24 BLUM

- Reversible
- 6 Acrylic bins included
- Blumotion full extension concealed drawer runners
- For VSB24-34

**Pull-out's shorter depth is designed for 24" Vanity Sink Base, but will also work in standard depth base cabinets. If used in standard base, there will be additional space in rear of cabinet once unit is installed.*



U-SHAPED VANITY SINK BASE PULL OUT

ITEM

OUVTCPO-30 BLUM

- Tandem plus Blumotion full extension drawer runners
- Designed for 30" Vanity Sink Base, but works great in standard depth base cabinets as well
- Non-skid vinyl lining
- 4 adjustable dividers
- 8 qt. waste container included

Any accessories can be ordered and installed through Fabuwood

Wall Accessories



FLOATING SHELF - TIMBER

ITEM
FLS24 TIMBER
FLS30 TIMBER
FLS36 TIMBER
FLS42 TIMBER
FLS48 TIMBER
FLS54 TIMBER
FLS60 TIMBER

- Includes hanging bracket & mounting hardware



FLOATING SHELF - WALNUT

ITEM
FLS24 WALNUT
FLS30 WALNUT
FLS36 WALNUT
FLS42 WALNUT
FLS48 WALNUT
FLS54 WALNUT
FLS60 WALNUT

- Includes hanging bracket & mounting hardware

Wall Accessories



FLOATING SHELF - BLACK MATTE

ITEM
FLS24 BLACK M
FLS30 BLACK M
FLS36 BLACK M
FLS42 BLACK M
FLS48 BLACK M
FLS54 BLACK M
FLS60 BLACK M

- Includes hanging bracket & mounting hardware



FLOATING SHELF - WHITE MATTE

ITEM
FLS24 WHITE M
FLS30 WHITE M
FLS36 WHITE M
FLS42 WHITE M
FLS48 WHITE M
FLS54 WHITE M
FLS60 WHITE M

- Includes hanging bracket & mounting hardware

Fillers

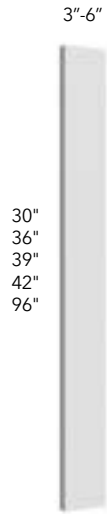

WALL, TALL & BASE

ITEM
WF330
WF336
WF339
WF342
WF630
WF636
WF639
WF642
TF396
TF696
BF3*
BF6*

- *Fillers are finished on two sides and edge-banded on all four edges*

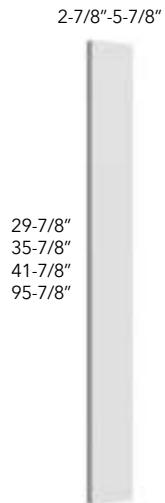

OVERLAY FILLER

ITEM
OLF330
OLF336
OLF342
OLF384
OLF390
OLF396
OLF630
OLF636
OLF642

- *Fillers are finished on two sides and edge-banded on all four edges*

Fillers

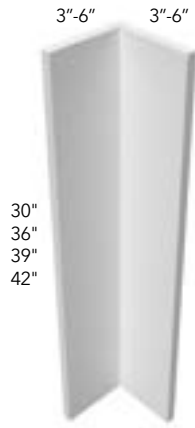

CORNER FILLER

ITEM
CF330
CF336
CF339
CF342
CF630
CF636
CF639
CF642

Columns

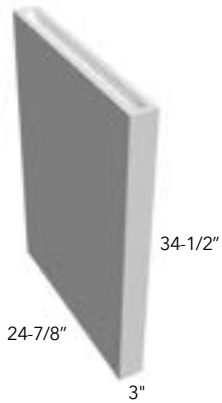

BASE COLUMN

ITEM

CLM-BASE

- Sides are flush finished
- Back is unfinished

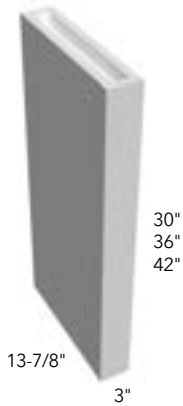

WALL COLUMNS

ITEM

CLM-30

CLM-36

CLM-39

CLM-42

- Sides are flush finished
- Back is unfinished

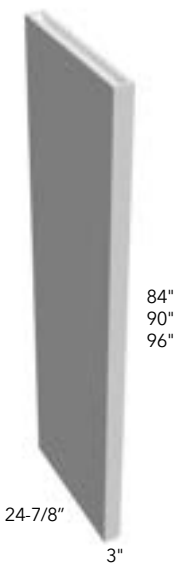

TALL COLUMN

ITEM

CLM-84

CLM-90

CLM-93

CLM-96

- Sides are flush finished
- Back is unfinished

End Panels

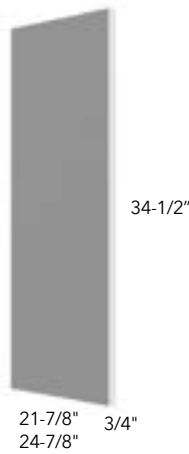

BASE END PANEL

ITEM

BEP

VBEP

- * Finished on two sides and edge-banded on all four edges
- Additional Edge-Band available for purchase
- BEP: 24-7/8"W x 34-1/2"H
- VBEP: 21-7/8"W x 34-1/2"H

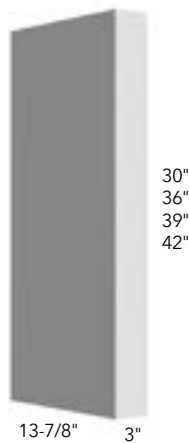

WALL END PANEL

ITEM

WEP1430 x 3

WEP1436 x 3

WEP1439 X 3

WEP1442 x 3

- * Finished on two sides and edge-banded on all four edges
- End panels with filler have flush finished sides and edge-banding on all four edges
- Additional Edge-Band available for purchase

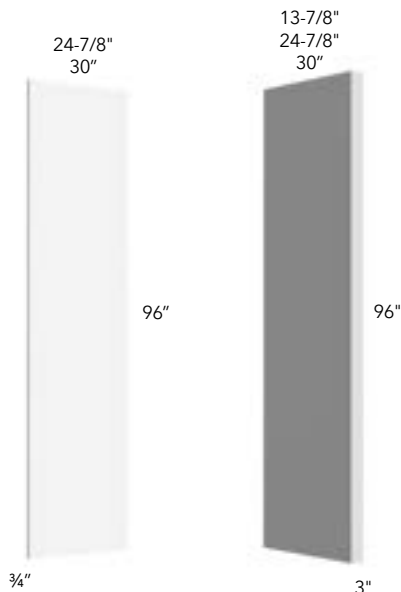

REFRIGERATOR END PANEL

ITEM

TEP*

REP2596*

REP3096*

REP1496 x 3

REP2596 x 3

REP3096 x 3

- * Finished on two sides and edge-banded on all four edges
- Edge-banded all around
- End panels with filler have flush finished sides and edge-banding on all four edges
- Additional Edge-Band available for purchase

Panels

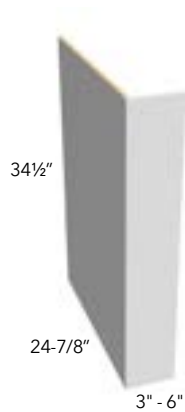
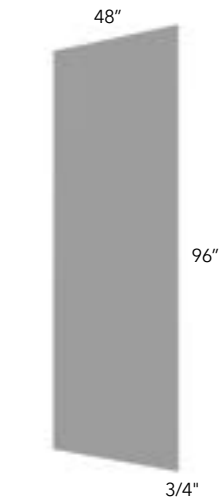

MDF

ITEM

PAN-3/4

PAN-3/4 4X9

- PAN-3/4: Signature Matte & Gloss Colors only
- PAN-3/4 4X9: Designer Collection Colors & Signature Textured Colors only
- Front side has full finish; Back side has reduced detail, matte finish
- No edge-band

DISHWASHER RETURN END PANEL

ITEM

DWR3

DWR6

- Dishwasher End Panels with filler have flush finished sides and edge-banding on all four edges
- Additional Edge-Band available for purchase

FINISHED END SKIN

ITEM

SK BASE

SK MC

SK TALL

SK T13D

SK W30

SK W36

SK W42

SK WD

- Available for the 4 Signature colors only (Bianco Matte, Bianco Gloss, Carbone Matte, Grigio Gloss)
- 1/16" thick skin has peel off adhesive backing
- Skin Dimensions:
 - » SK BASE: 24" x 30"
 - » SK MC: 20" x 42"
 - » SK TALL: 24" x 96"
 - » SK T13D: 13" x 96"
 - » SK W30: 13" x 30"
 - » SK W36: 13" x 36"
 - » SK W42: 13" x 42"
 - » SK WD: 15" x 60"

Wainscot Panels

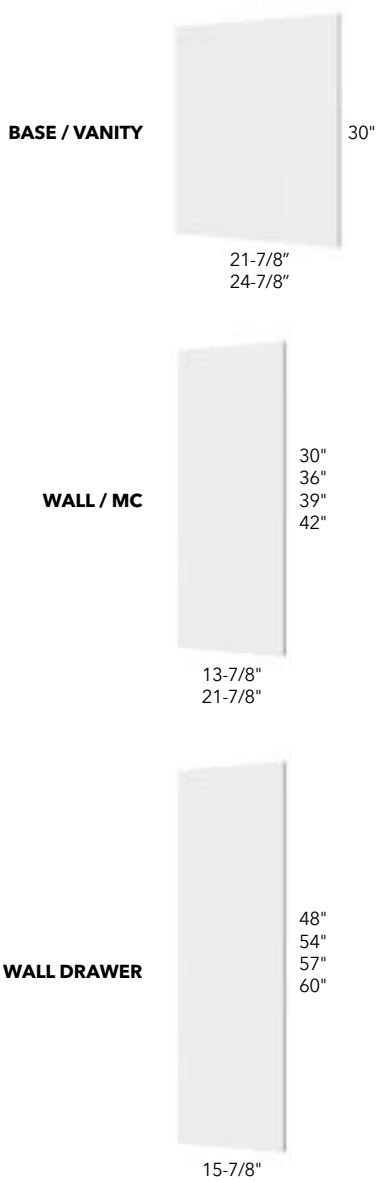

WAINSCOT PANEL - BASE & WALL

ITEM
WP-BASE
WP-VBASE
WP-W12
WP-W15
WP-W18
WP-W21
WP-W24
WP-W30
WP-W36
WP-W39
WP-W42
WP-MC30
WP-MC36
WP-MC39
WP-MC42
WP-WD48
WP-WD54
WP-WD57
WP-WD60
WP-W1224D
WP-W1524D
WP-W1824D
WP-W2124D
WP-W2424D

- Same profile as cabinet door (3/4" thick)
- Dimensions:
 - Base: 24-7/8"W x 30"H
 - Vanity Base (21"D): 21-7/8"W x 30"H
 - Wall (13"D): 13-7/8"W x 30"H / 36"H / 42"H
 - Wall (24"D): 24-7/8"W x 12"H / 15"H / 18"H / 24"H
 - Wall Microwave (21"D): 21-7/8"W x 30"H / 36"H / 42"H
 - Wall Drawer (15"D): 15-7/8"W x 48"H / 54"H / 60"H

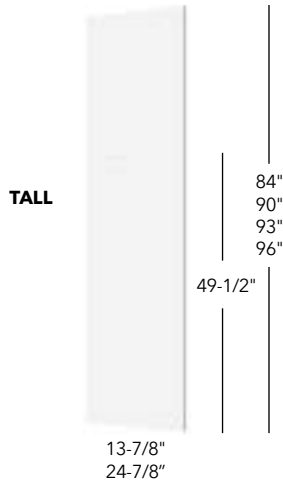

WAINSCOT PANEL - TALL

ITEM
WP-T84
WP-T90
WP-T93
WP-T96
WP-T8413D
WP-T9013D
WP-T9313D
WP-T9613D

- Same profile as cabinet door (3/4" thick)
- Dimensions:
 - Tall (13"D): 13-7/8"W x 84"H / 90"H / 96"H
Note: Bottom door is 49-1/2"H
 - Tall (24"D): 24-7/8"W x 84"H / 90"H / 96"H
Note: Bottom door is 49-1/2"H

Moldings (8')



TOE KICK

ITEM

TK8-3/4

BBM

- Edge-banded on all 4 edges
- Additional Edge-Band available for purchase

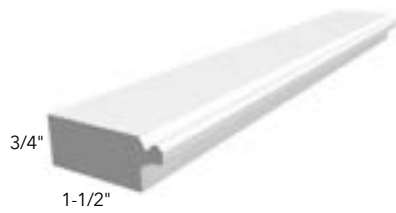

STARTER

ITEM

STRM-8



LIGHT RAIL

ITEM

LRM

- Use with STRM-8 to install LRM to be flushed with front of door

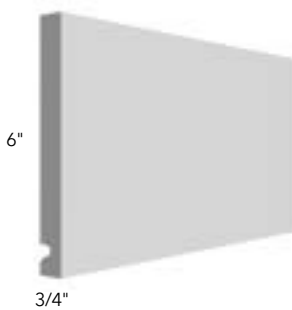

STRAIGHT VALANCE

ITEM

VST-6

- Use STRM-8 for Soffit build-up

EXAMPLES OF STRM-8 APPLICATION:



LRM + STRM-8



VST-6 + STRM-8

Cabinet Lighting



LED FLS30 WALNUT SHOWN

FLOATING SHELF WITH LED - TIMBER

ITEM
LED FLS24 TIMBER
LED FLS30 TIMBER
LED FLS36 TIMBER
LED FLS42 TIMBER
LED FLS48 TIMBER
LED FLS54 TIMBER
LED FLS60 TIMBER

FLOATING SHELF WITH LED - WALNUT

ITEM
LED FLS24 WALNUT
LED FLS30 WALNUT
LED FLS36 WALNUT
LED FLS42 WALNUT
LED FLS48 WALNUT
LED FLS54 WALNUT
LED FLS60 WALNUT

- Dimmable. Settings allow for adjustment between Warm White to Cool White lighting
- Light temperature range of 2700-5000K
- Floating shelves include a Light Bar with 6.5ft Lead and a 6.5ft Extension Lead
- LED Light Bar for Floating Shelves ship loose and are to be installed in the field
- Channel is pre-routed to accommodate LED light bar installation
- Floating Shelves with LED are available in Stock Paint and Stain Finishes, Walnut and are to be specified at time of order. For Finishing to a custom color, must be ordered as Dove or Frost.
- Requires Driver, Mesh Connector, & Recommended Light Switch (purchased separately).

Note: Installation by a qualified cabinetry installer or electrician is recommended.

Cabinet Lighting



FLOATING SHELF WITH LED - BLACK MATTE

ITEM
LED FLS24 BLACK M
LED FLS30 BLACK M
LED FLS36 BLACK M
LED FLS42 BLACK M
LED FLS48 BLACK M
LED FLS54 BLACK M
LED FLS60 BLACK M



FLOATING SHELF WITH LED - WHITE MATTE

ITEM
LED FLS24 WHITE M
LED FLS30 WHITE M
LED FLS36 WHITE M
LED FLS42 WHITE M
LED FLS48 WHITE M
LED FLS54 WHITE M
LED FLS60 WHITE M

- Dimmable. Settings allow for adjustment between Warm White to Cool White lighting
- Light temperature range of 2700-5000K
- Floating shelves include a Light Bar with 6.5ft Lead and a 6.5ft Extension Lead
- LED Light Bar for Floating Shelves ship loose and are to be installed in the field
- Channel is pre-routed to accommodate LED light bar installation
- Floating Shelves with LED are available in Stock Paint and Stain Finishes, Walnut and are to be specified at time of order. For Finishing to a custom color, must be ordered as Dove or Frost.
- Requires Driver, Mesh Connector, & Recommended Light Switch (purchased separately).

Note: Installation by a qualified cabinetry installer or electrician is recommended.

Height Alignment Guide

84" Height Alignment

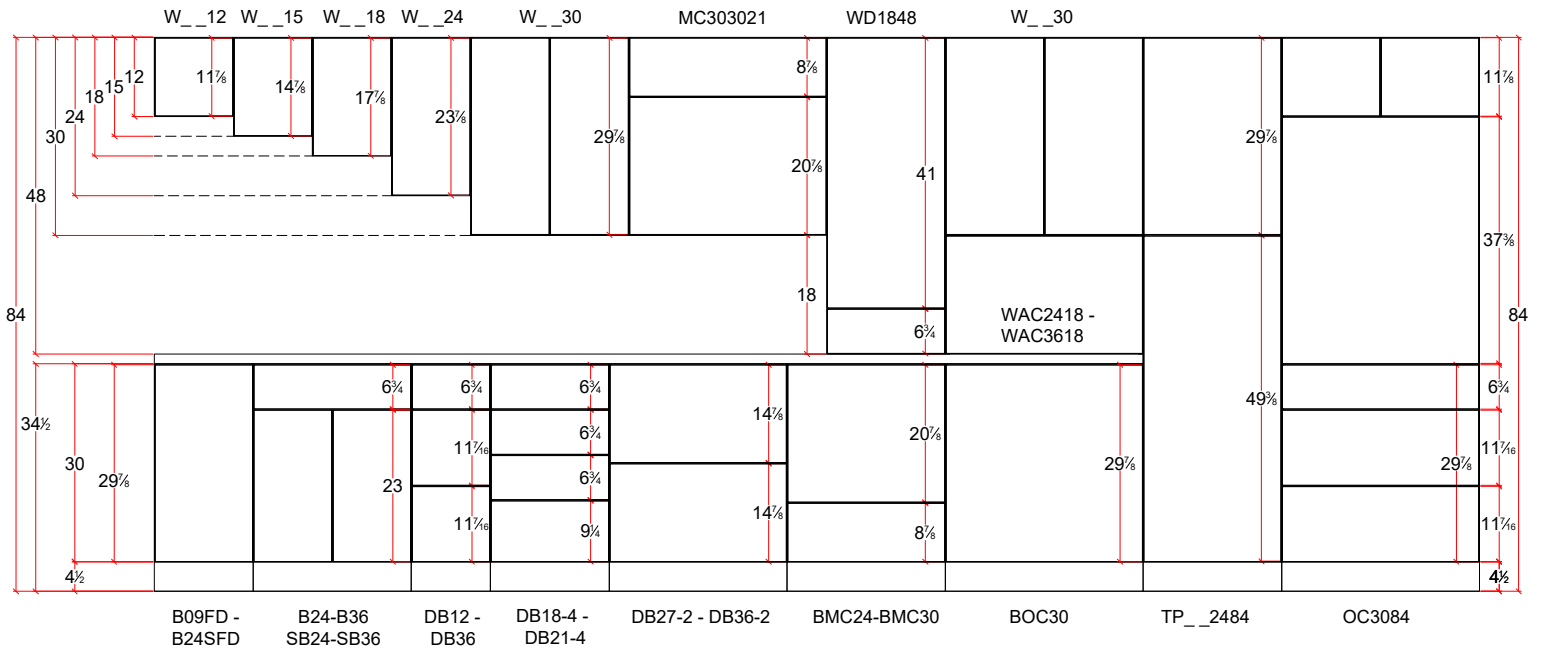

90" Height Alignment

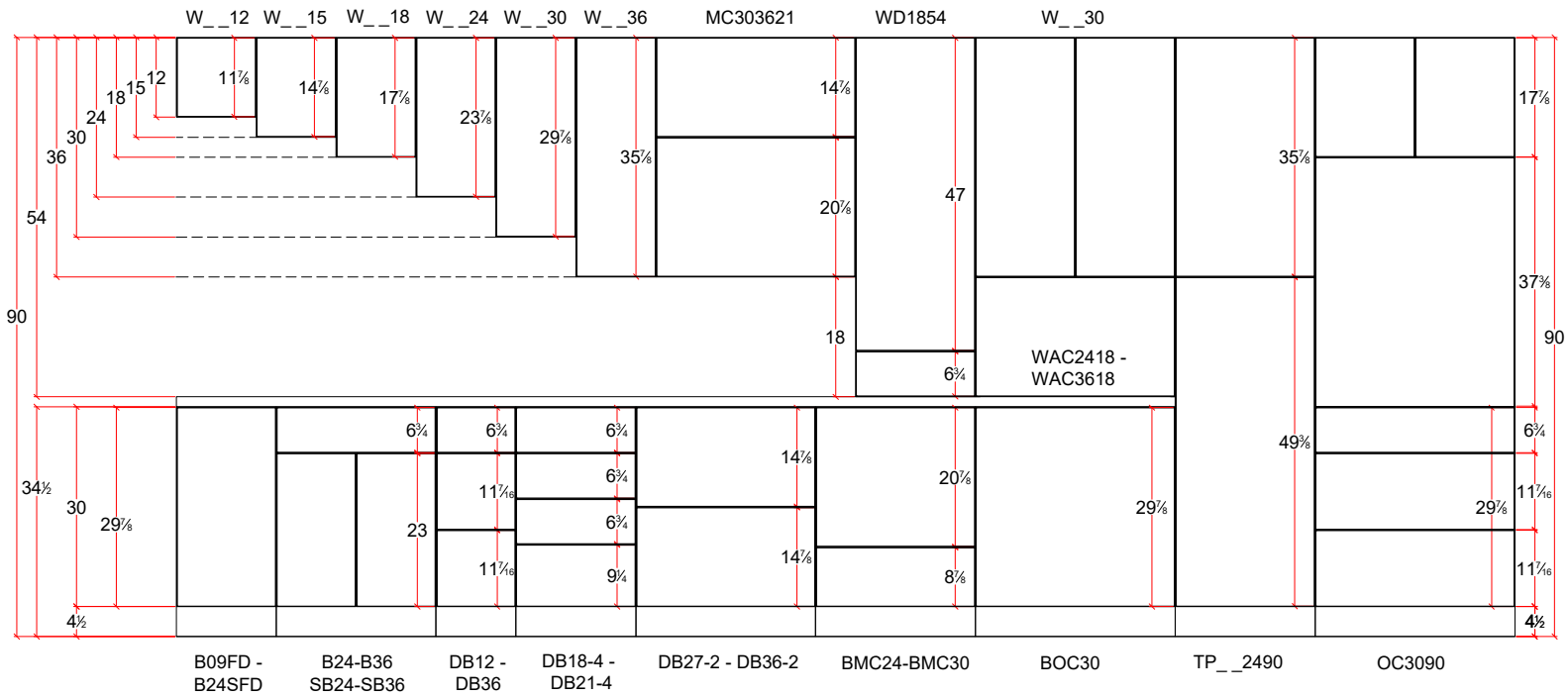

93" Height Alignment

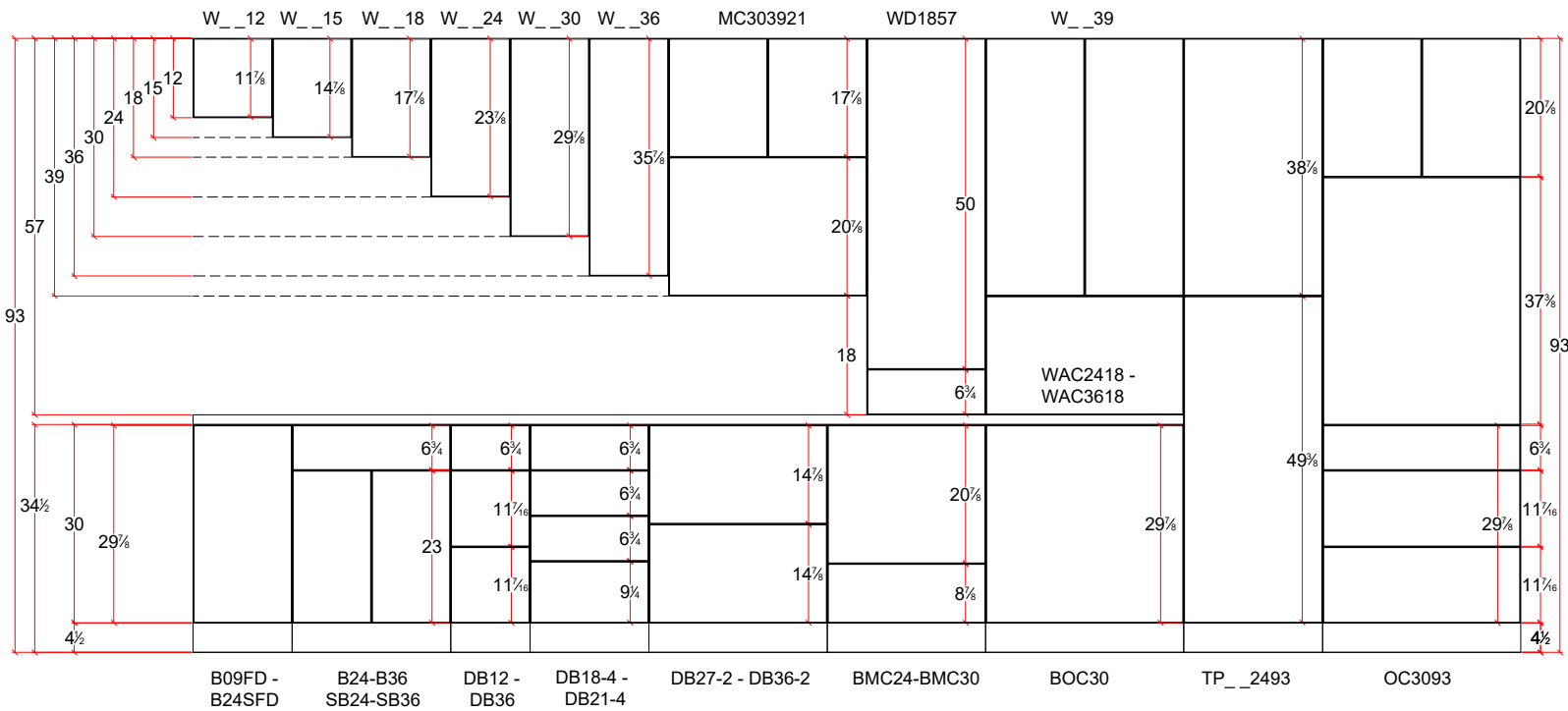

Copyright © 2026 by Fabuwood Cabinetry Corp.

All rights reserved.

No part of this publication may be reproduced, distributed, or transmitted in any form or by any means, including photocopying, scanning, or other electronic or mechanical methods, including online sharing, without the prior written permission of Fabuwood Cabinetry Corp.

